



**SCHUTZ-
STROMWANDLER
KATALOG**



GMW – Wir machen Ihre Werte sichtbar

Wir bieten unseren Kunden mit unseren Produkten das komplette Spektrum zur Lösung aller EMAS-Aufgaben und damit Instrumente zur nachhaltigen Nutzung elektrischer Energie. Als Komplettanbieter realisieren wir auch das ganze Projekt von A-Z von der Projektberatung bis zur Inbetriebnahme sowie Schulungs- und Wartungsmaßnahmen.

Schutz-Rohrstab-Stromwandler

Schutz-Aufsteck-Stromwandler



GERÄTETESTER



NIEDERSpannungs- UND MITTELSPANNUNGS-STROMWANDLER



ENERGIEMANAGEMENT



ANALOGUE ANZEIGENGERÄTE



DIGITALE EINBAUMESSGERÄTE



MESSUMFORMER



TEXTANZEIGER UND DRUCKER



TASTKÖPFE UND MESSZUBEHÖR



SCHALTSCHRANK-KOMPONENTEN



ZUBEHÖR

Allgemein		ab Seite 2
Produktübersicht GMW		Seite 2
Inhaltsverzeichnis		Seite 3
Schutz-Stromwandler	Technische Begriffe	Seite 4

Schutz-Rohrstab-Stromwandler				Seite 5
	Primärleiter	Rundleiter	Wandlerbreite	
SASR 22.3		ø 22,5mm	61mm	Seite 5

Schutz-Aufsteck-Stromwandler				ab Seite 6
	Primärleiter	Rundleiter	Wandlerbreite	
SASK 21.3	20x10 mm	ø 19,2 mm	61 mm	Seite 6
SASK 31.5	30x10 mm/2x20x10 mm	ø 28 mm	61 mm	Seite 7
SASK 31.6	30x10 mm/20x13 mm	ø 23 mm	95 mm	Seite 8
SASK 421.4	20x10 mm	ø 20 mm	71 mm	Seite 12
SASK 41.4	40x10 mm/2x30x5 mm	ø 32 mm	71 mm	Seite 13
SASK 41.6	40x12 mm/30x5 mm	ø 32 mm	95 mm	Seite 14
SASK 41.10	40x10 mm	ø 32 mm	150 mm	Seite 16
SASK 541.4	40x10 mm/20x30x15 mm	ø 32 mm	86 mm	Seite 20
SASK 51.4	50x12 mm/2x40x10 mm	ø 44 mm	86 mm	Seite 22
SASK 51.6	50x12 mm/40x30 mm	ø 40 mm	95 mm	Seite 23
SASK 61.4	60x10 mm/2x50x10 mm	ø 44 mm	96 mm	Seite 26
SASK 61.10	60x10 mm/50x30 mm		150 mm	Seite 27
SASK 63.6	60x30 mm	ø 30 mm	88 mm	Seite 31
SASK 105.6	100x55 mm	ø 55 mm	129 mm	Seite 32

Schutz-Stromwandler – Technische Begriffe

Anwendung: Stromwandler dienen der galvanisch getrennten, proportionalen Umwandlung von Wechselströmen großer Stromstärken in kleinere, direkt messbare Werte. Entsprechend ihrer Verwendung erfolgt eine Unterscheidung in zwei Typen:

- Messwandler
- Schutzwandler

Alle Stromwandler sind für den Einsatz in Niederspannungsnetzen mit einer maximalen Leiter-Leiter-Spannung von 0,72 kV konzipiert.

Messwandler: Messwandler werden zur Messung von Strom, Leistung, Leistungsfaktor und Energieverbrauch unter direkter Verwendung eines entsprechenden Messgerätes verwendet. Durch die Dimensionierung ihres magnetischen Kreises ermöglichen Messwandler eine hohe Übertragungsgenauigkeit im Nennstrombereich, bei gleichzeitigem Schutz der angeschlossenen Geräte im Überstromfall. Dieser Schutz wird durch die im Überstromfall eintretende magnetische Sättigung des Messkernes verursacht.

Schutzwandler: Schutzstromwandler dienen der Ansteuerung von Schutzrelais, welche die Aufgabe haben, nachgeschaltete Schaltungen im Überstromfall zu trennen. Für eine sichere Funktion dieser Relais ist ein proportionales Übertragungsverhalten des Wandlers bis zu einem Vielfachen des Nennstromes erforderlich. Die Dimensionierung dieser Wandlerbauform stellt eine proportionale Stromübertragung bis zu einem von der Schutzklasse bestimmten Vielfachen des Nennstroms sicher.

Technische Normen: Alle Stromwandler werden in Übereinstimmung mit den technischen Forderungen der IEC 61869/1+2 (vormals IEC 60044-1) gefertigt.

Technische Merkmale: Einsatzort: Innenräume, ohne Betauung.

Schutz-Stromwandler:

- Umgebungstemperaturbereich: $-5^{\circ}\text{C} \dots +40^{\circ}\text{C}$.
- Gehäusematerial: Polykarbonat, selbstverlöschend
- Gehäusebauform: Halbschalengehäuse, ultraschallverschweißt
- Isolierstoffklasse: E
- Thermische Bemessungs-Dauerstromstärke: $1.2 \times I_N$
- Sekundäre Bemessungs-Stromstärken: 5 A bzw. 1 A
- Thermische Bemessungs-Kurzzeitstromstärke: $60 \times I_N$ (max. 100 kA)
- Max. Übertemperatur der Sekundärwicklung: 75 K
- Isolationsprüfspannung: $3 \text{ kV } U_{\text{eff}}$; 50 Hz, 1 min

Sicherheitshinweis: Bedingt durch das physikalische Wirkprinzip können beim Betrieb des Stromwandlers mit offenem Sekundärkreis an dessen Anschlussklemmen für den Menschen gefährliche Spannungen auftreten. Besonders bei Schutz-Stromwandlern können dabei Spannungen von mehreren Kilovolt auftreten. Zur Vermeidung von Personen- bzw. Wandler Schäden ist ein solcher Betriebszustand untersagt!

Bestellhinweis: Zur korrekten Bearbeitung Ihrer Bestellung bitten wir um vollständige Übermittlung folgender Angaben:

Wandlertyp
Übersetzungsverhältnis
Genauigkeitsklasse
Bemessungsbürde

Genauigkeitsklassen von Stromwandlern														
Klasse	Stromfehler (\pm %) bei % I_N							Fehlwinkel (\pm Minuten) bei % I_N						Gesamtfehler bei $n \times I_N$
	1 %	5 %	20 %	50 %	100 %	120 %		1 %	5 %	20 %	50 %	100 %	120 %	
Schutz-Stromwandler														
5P(n)	-	3,00	1,50	-	1,00	1,00		-	180	90	-	60	60	< 5
10P(n)	-	-	-	3,00	3,00	3,00		-	-	-	120	120	120	<10
n... Überstrombegrenzungsfaktor														

SASR 22.3



Schutz-Rohrstab-Stromwandler

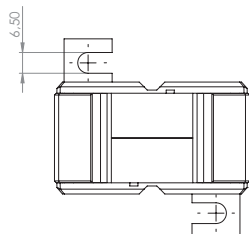
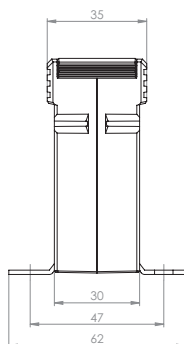
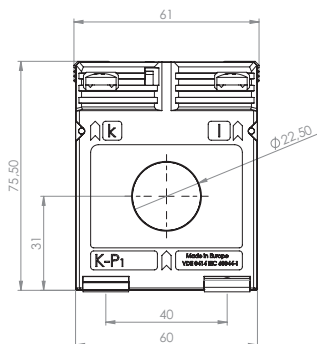

Rundleiter 22,5 mm
 Baubreite 61 mm
 Bauhöhe 75,5 mm
 Bautiefe gesamt 35 mm



Primärstrom [A]	Bürde [VA]	Sekundärstrom [A] / Klasse			
		5 A Kl. 5P5 Best.-Nr.	5 A Kl. 10P5 Best.-Nr.	1 A Kl. 5P5 Best.-Nr.	1 A Kl. 10P5 Best.-Nr.
100	1			100S04-1316B	100S04-1317B
125	1	100S04-1506B	100S04-1507B		
	1,5			100S04-1516C	100S04-1517C
150	1	100S04-1606B	100S04-1607B		
	1,5			100S04-1616C	100S04-1617C
200	1	100S04-1706B	100S04-1707B		
	1,5			100S04-1716C	100S04-1717C
250	1	100S04-1806B	100S04-1807B		
	1,5			100S04-1816C	100S04-1817C
300	1	100S04-1906B	100S04-1907B		
	1,5		100S04-1907C	100S04-1916C	100S04-1917C

		Best.-Nr.
	Schnappbefestigung Form A	10053011
	Plombierplatte Form A	10059040

SASK 21.3

Schutz-Aufsteck-Stromwandler



Schiene 1 20 x 10 mm
 Rundleiter 19,2 mm
 Baubreite 61 mm
 Bauhöhe 75,5 mm
 Bautiefe gesamt 48 mm

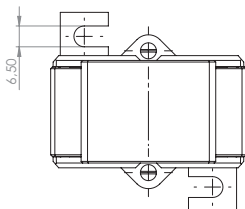
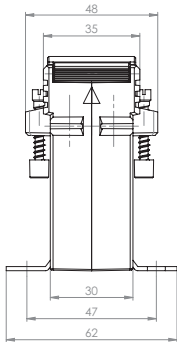
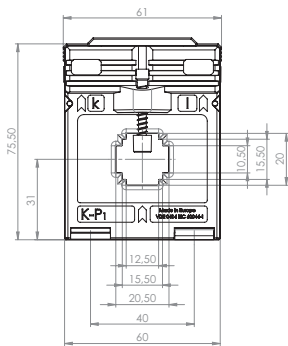

Primärstrom [A]	Bürde [VA]	Sekundärstrom [A] / Klasse			
		5 A Kl. 5P5 Best.-Nr.	5 A Kl. 10P5 Best.-Nr.	1 A Kl. 5P5 Best.-Nr.	1 A Kl. 10P5 Best.-Nr.
125	1	100S03-1506B	100S03-1507B		
	1,5			100S03-1516C	100S03-1517C
150	1	100S03-1606B	100S03-1607B		
	1,5			100S03-1616C	100S03-1617C
200	1	100S03-1706B	100S03-1707B		
	1,5			100S03-1716C	100S03-1717C

		Best.-Nr.
	Schnappbefestigung Form A	10053011
	Plombierplatte Form A	10059040

SASK 31.5

Schutz-Aufsteck-Stromwandler



- Schiene 1 30 x 10 mm
- Schiene 2 2 x 20 x 10 mm
- Rundleiter 28 mm
- Baubreite 61 mm
- Bauhöhe 75,5 mm
- Bautiefe gesamt 68 mm

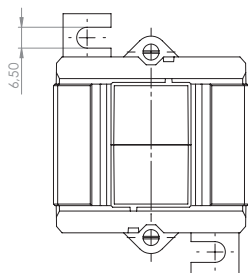
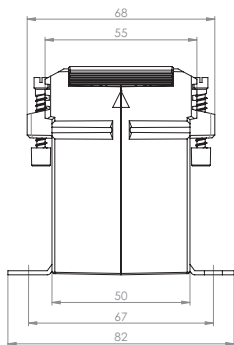
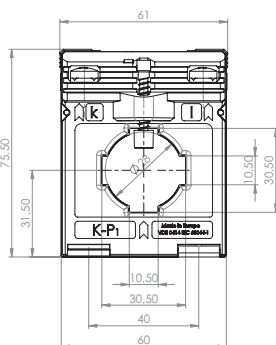

Primärstrom [A]	Bürde [VA]	Sekundärstrom [A] / Klasse			
		5 A Kl. 5P5 Best.-Nr.	5 A Kl. 10P5 Best.-Nr.	1 A Kl. 5P5 Best.-Nr.	1 A Kl. 10P5 Best.-Nr.
75	1			100S17-1116B	100S17-1117B
80	1			100S17-1216B	100S17-1217B
100	1	100S17-1306B	100S17-1307B		
	1,5			100S17-1316C	100S17-1317C
125	1	100S17-1506B	100S17-1507B		
	1,5		100S17-1507C	100S17-1516C	100S17-1517C
150	1	100S17-1606B	100S17-1607B		
	1,5	100S17-1606C	100S17-1607C	100S17-1616C	100S17-1617C
200	1	100S17-1706B	100S17-1707B		
	1,5	100S17-1706C	100S17-1707C	100S17-1716C	100S17-1717C
	2,5	100S17-1706D	100S17-1707D	100S17-1716D	100S17-1717D
250	1,5	100S17-1806C	100S17-1807C	100S17-1816C	100S17-1817C
	2,5	100S17-1806D	100S17-1807D	100S17-1816D	100S17-1817D
300	1,5	100S17-1906C	100S17-1907C	100S17-1916C	100S17-1917C
	2,5	100S17-1906D	100S17-1907D	100S17-1916D	100S17-1917D
400	1,5	100S17-2006C	100S17-2007C	100S17-2016C	100S17-2017C
	2,5	100S17-2006D	100S17-2007D	100S17-2016D	100S17-2017D
500	1,5	100S17-2106C	100S17-2107C	100S17-2116C	100S17-2117C
	2,5	100S17-2106D	100S17-2107D	100S17-2116D	100S17-2117D
600	1,5	100S17-2206C	100S17-2207C	100S17-2216C	100S17-2217C
	2,5	100S17-2206D	100S17-2207D	100S17-2216D	100S17-2217D
750	1,5	100S17-2306C	100S17-2307C	100S17-2316C	100S17-2317C
	2,5	100S17-2306D	100S17-2307D	100S17-2316D	100S17-2317D

		Best.-Nr.
	Schnappbefestigung Form C	10055011
	Plombierplatte Form B	10059041

SASK 31.6

Schutz-Aufsteck-Stromwandler



- Schiene 1 30 x 10 mm
- Schiene 2 20 x 13 mm
- Rundleiter 23 mm
- Baubreite 95 mm
- Bauhöhe 116 mm
- Bautiefe gesamt 74 mm

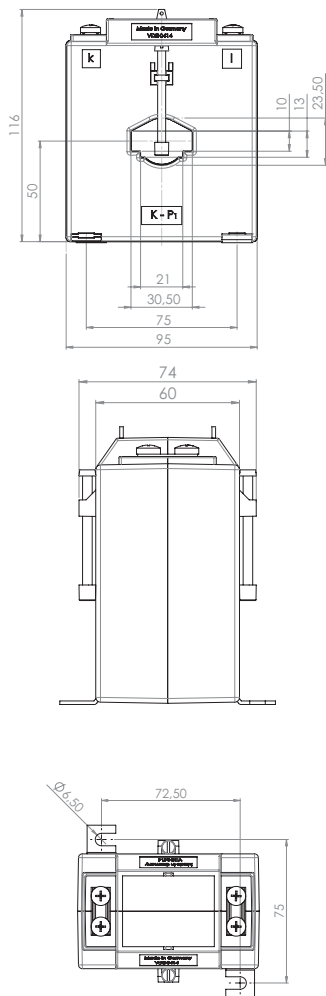

Primärstrom [A]	Bürde [VA]	Sekundärstrom [A] / Klasse		
		5 A Kl. 5P5 Best.-Nr.	5 A Kl. 10P5 Best.-Nr.	5 A Kl. 5P10 Best.-Nr.
50	1,5	100S19-0906C	100S19-0907C	
	2,5	100S19-0906D	100S19-0907D	
60	1,5	100S19-1006C	100S19-1007C	
	2,5	100S19-1006D	100S19-1007D	
80	1,5			100S19-1208C
	2,5	100S19-1206D	100S19-1207D	
	5	100S19-1206F	100S19-1207F	
100	1,5	100S19-1306C	100S19-1307C	100S19-1308C
	2,5	100S19-1306D	100S19-1307D	100S19-1308D
	5	100S19-1306F	100S19-1307F	
150	2,5	100S19-1606D	100S19-1607D	100S19-1608D
	5	100S19-1606F	100S19-1607F	100S19-1608F
	7,5	100S19-1606G	100S19-1607G	
200	2,5	100S19-1706D	100S19-1707D	100S19-1708D
	5	100S19-1706F	100S19-1707F	100S19-1708F
	7,5	100S19-1706G	100S19-1707G	
	10	100S19-1706H	100S19-1707H	
250	2,5	100S19-1806D	100S19-1807D	100S19-1808D
	5	100S19-1806F	100S19-1807F	100S19-1808F
	7,5	100S19-1806G	100S19-1807G	
	10	100S19-1806H	100S19-1807H	
300	2,5	100S19-1906D	100S19-1907D	100S19-1908D
	5	100S19-1906F	100S19-1907F	100S19-1908F
	10	100S19-1906H	100S19-1907H	
400	2,5	100S19-2006D	100S19-2007D	100S19-2008D
	5	100S19-2006F	100S19-2007F	100S19-2008F
	7,5	100S19-2006G	100S19-2007G	100S19-2008G
	10	100S19-2006H	100S19-2007H	100S19-2008H
	15	100S19-2006J	100S19-2007J	
500	2,5	100S19-2106D	100S19-2107D	100S19-2108D
	5	100S19-2106F	100S19-2107F	100S19-2108F
	7,5	100S19-2106G	100S19-2107G	100S19-2108G
	10	100S19-2106H	100S19-2107H	100S19-2108H
	15	100S19-2106J	100S19-2107J	
600	2,5	100S19-2206D	100S19-2207D	100S19-2208D
	5	100S19-2206F	100S19-2207F	100S19-2208F
	7,5	100S19-2206G	100S19-2207G	100S19-2208G
	10	100S19-2206H	100S19-2207H	100S19-2208H
	15	100S19-2206J	100S19-2207J	
750	2,5	100S19-2306D	100S19-2307D	100S19-2308D
	5	100S19-2306F	100S19-2307F	100S19-2308F
	7,5	100S19-2306G	100S19-2307G	100S19-2308G
	10	100S19-2306H	100S19-2307H	100S19-2308H
	15	100S19-2306J	100S19-2307J	

SASK 31.6

Schutz-Aufsteck-Stromwandler



- Schiene 1 30 x 10 mm
- Schiene 2 20 x 13 mm
- Rundleiter 23 mm
- Baubreite 95 mm
- Bauhöhe 116 mm
- Bautiefe gesamt 74 mm

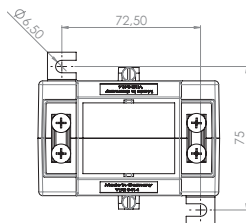
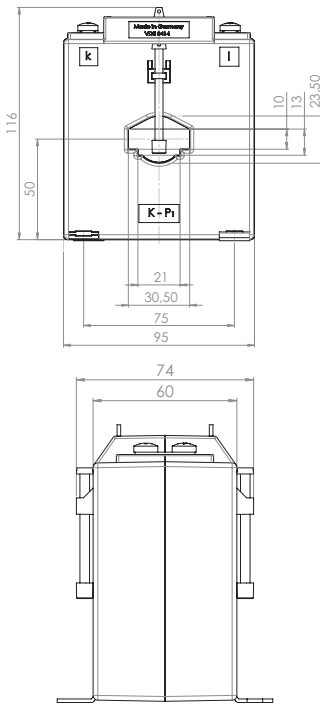

Primärstrom [A]	Bürde [VA]	Sekundärstrom [A] / Klasse		
		5 A Kl. 10P10 Best.-Nr.	5 A Kl. 5P15 Best.-Nr.	5 A Kl. 10P15 Best.-Nr.
60	1,5	100S19-1009C		
80	1,5	100S19-1209C		
100	1,5	100S19-1309C	100S19-130AC	100S19-130BC
	2,5	100S19-1309D		
150	2,5	100S19-1609D	100S19-160AD	100S19-160BD
	5	100S19-1609F		
200	2,5	100S19-1709D	100S19-170AD	100S19-170BD
	5	100S19-1709F		
250	2,5	100S19-1809D	100S19-180AD	100S19-180BD
	5	100S19-1809F		
300	2,5	100S19-1909D	100S19-190AD	100S19-190BD
	5	100S19-1909F		
400	2,5	100S19-2009D	100S19-200AD	100S19-200BD
	5	100S19-2009F	100S19-200AF	100S19-200BF
	7,5	100S19-2009G		
	10	100S19-2009H		
500	2,5	100S19-2109D	100S19-210AD	100S19-210BD
	5	100S19-2109F	100S19-210AF	100S19-210BF
	7,5	100S19-2109G		
	10	100S19-2109H		
600	2,5	100S19-2209D	100S19-220AD	100S19-220BD
	5	100S19-2209F	100S19-220AF	100S19-220BF
	7,5	100S19-2209G		
	10	100S19-2209H		
750	2,5	100S19-2309D	100S19-230AD	100S19-230BD
	5	100S19-2309F	100S19-230AF	100S19-230BF
	7,5	100S19-2309G		
	10	100S19-2309H		

		Best.-Nr.
	Schnappbefestigung	-
	Plombierplatte Form E	10059044

SASK 31.6

Schutz-Aufsteck-Stromwandler



- Schiene 1 30 x 10 mm
- Schiene 2 20 x 13 mm
- Rundleiter 23 mm
- Baubreite 95 mm
- Bauhöhe 116 mm
- Bautiefe gesamt 74 mm

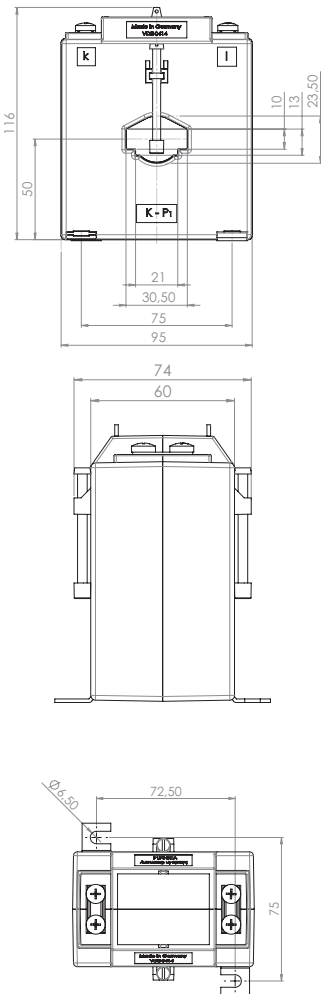

Primärstrom [A]	Bürde [VA]	Sekundärstrom [A] / Klasse		
		1 A Kl. 5P5 Best.-Nr.	1 A Kl. 10P5 Best.-Nr.	1 A Kl. 5P10 Best.-Nr.
50	1,5	100S19-0916C	100S19-0917C	
	2,5	100S19-0916D	100S19-0917D	
60	1,5	100S19-1016C	100S19-1017C	100S19-1018C
	2,5	100S19-1016D	100S19-1017D	
80	1,5	100S19-1216C	100S19-1217C	100S19-1218C
	2,5	100S19-1216D	100S19-1217D	100S19-1218D
	5		100S19-1217F	
100	2,5	100S19-1316D	100S19-1317D	100S19-1318D
	5	100S19-1316F	100S19-1317F	
150	2,5	100S19-1616D	100S19-1617D	100S19-1618D
	5	100S19-1616F	100S19-1617F	100S19-1618F
200	2,5	100S19-1716D	100S19-1717D	100S19-1718D
	5	100S19-1716F	100S19-1717F	100S19-1718F
	7,5	100S19-1716G	100S19-1717G	
	10	100S19-1716H	100S19-1717H	
250	2,5	100S19-1816D	100S19-1817D	100S19-1818D
	5	100S19-1816F	100S19-1817F	100S19-1818F
	7,5	100S19-1816G	100S19-1817G	
	10	100S19-1816H	100S19-1817H	
300	2,5	100S19-1916D	100S19-1917D	100S19-1918D
	5	100S19-1916F	100S19-1917F	100S19-1918F
	10	100S19-1916H	100S19-1917H	
400	2,5	100S19-2016D	100S19-2017D	100S19-2018D
	5	100S19-2016F	100S19-2017F	100S19-2018F
	7,5	100S19-2016G	100S19-2017G	100S19-2018G
	10	100S19-2016H	100S19-2017H	100S19-2018H
500	15	100S19-2016J	100S19-2017J	
	2,5	100S19-2116D	100S19-2117D	100S19-2118D
	5	100S19-2116F	100S19-2117F	100S19-2118F
	7,5	100S19-2116G	100S19-2117G	100S19-2118G
600	10	100S19-2116H	100S19-2117H	100S19-2118H
	15	100S19-2116J	100S19-2117J	
	2,5	100S19-2216D	100S19-2217D	100S19-2218D
	5	100S19-2216F	100S19-2217F	100S19-2218F
750	7,5	100S19-2216G	100S19-2217G	100S19-2218G
	10	100S19-2216H	100S19-2217H	100S19-2218H
	15	100S19-2216J	100S19-2217J	
	2,5	100S19-2316D	100S19-2317D	100S19-2318D
750	5	100S19-2316F	100S19-2317F	100S19-2318F
	7,5	100S19-2316G	100S19-2317G	100S19-2318G
	10	100S19-2316H	100S19-2317H	100S19-2318H
	15	100S19-2316J	100S19-2317J	

SASK 31.6

Schutz-Aufsteck-Stromwandler



- Schiene 1 30 x 10 mm
- Schiene 2 20 x 13 mm
- Rundleiter 23 mm
- Baubreite 95 mm
- Bauhöhe 116 mm
- Bautiefe gesamt 74 mm

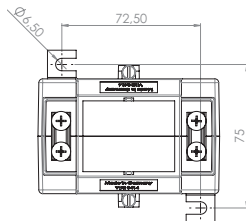
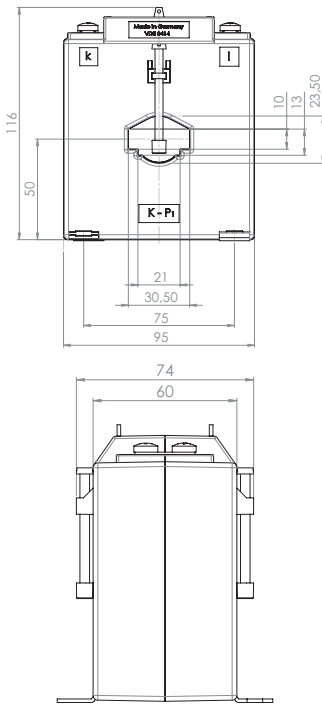

Primärstrom [A]	Bürde [VA]	Sekundärstrom [A] / Klasse		
		1 A Kl. 10P10 Best.-Nr.	1 A Kl. 5P15 Best.-Nr.	1 A Kl. 10P15 Best.-Nr.
60	1,5	100S19-1019C		
80	1,5	100S19-1219C		
	2,5	100S19-1219D		
100	1,5		100S19-131AC	100S19-131BC
	2,5	100S19-1319D		
150	2,5	100S19-1619D	100S19-161AD	100S19-161BD
	5	100S19-1619F		
200	2,5	100S19-1719D	100S19-171AD	100S19-171BD
	5	100S19-1719F		
250	2,5	100S19-1819D	100S19-181AD	100S19-181BD
	5	100S19-1819F		
300	2,5	100S19-1919D	100S19-191AD	100S19-191BD
	5	100S19-1919F		
400	2,5	100S19-2019D	100S19-201AD	100S19-201BD
	5	100S19-2019F	100S19-201AF	100S19-201BF
	7,5	100S19-2019G		
	10	100S19-2019H		
500	2,5	100S19-2119D	100S19-211AD	100S19-211BD
	5	100S19-2119F	100S19-211AF	100S19-211BF
	7,5	100S19-2119G		
600	10	100S19-2119H		
	2,5	100S19-2219D	100S19-221AD	100S19-221BD
	5	100S19-2219F	100S19-221AF	100S19-221BF
	7,5	100S19-2219G		
750	10	100S19-2219H		
	2,5	100S19-2319D	100S19-231AD	100S19-231BD
	5	100S19-2319F	100S19-231AF	100S19-231BF
750	7,5	100S19-2319G		
	10	100S19-2319H		

		Best.-Nr.
	Schnappbefestigung	-
	Plombierplatte Form E	10059044

SASK 421.4

Schutz-Aufsteck-Stromwandler



Schiene 1 20 x 10 mm
 Rundleiter 20 mm
 Baubreite 71 mm
 Bauhöhe 85,5 mm
 Bautiefe gesamt 58 mm

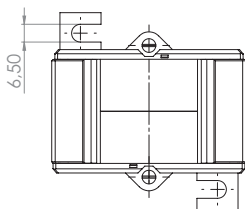
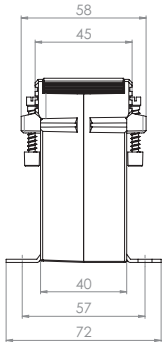
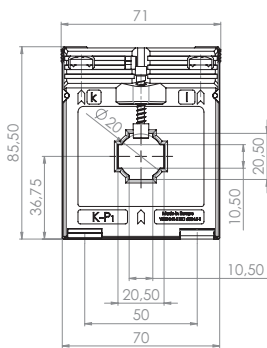

Primärstrom [A]	Bürde [VA]	Sekundärstrom [A] / Klasse			
		5 A Kl. 5P5 Best.-Nr.	5 A Kl. 10P5 Best.-Nr.	1 A Kl. 5P5 Best.-Nr.	1 A Kl. 10P5 Best.-Nr.
100	2,5	100S23-1306D	100S23-1307D	100S23-1316D	100S23-1317D
150	2,5	100S23-1606D	100S23-1607D	100S23-1616D	100S23-1617D
200	1,5	100S23-1706C	100S23-1707C	100S23-1716C	100S23-1717C
	2,5	100S23-1706D	100S23-1707D	100S23-1716D	100S23-1717D
250	1,5	100S23-1806C	100S23-1807C	100S23-1816C	100S23-1817C
	2,5	100S23-1806D	100S23-1807D	100S23-1816D	100S23-1817D
300	1,5	100S23-1906C	100S23-1907C	100S23-1916C	100S23-1917C
	2,5	100S23-1906D	100S23-1907D	100S23-1916D	100S23-1917D
400	1,5	100S23-2006C	100S23-2007C	100S23-2016C	100S23-2017C
	2,5	100S23-2006D	100S23-2007D	100S23-2016D	100S23-2017D

		Best.-Nr.
	Schnappbefestigung	-
	Plombierplatte Form B	10059041

SASK 41.4

Schutz-Aufsteck-Stromwandler



- Schiene 1 40 x 10 mm
- Schiene 2 2 x 30 x 5 mm
- Rundleiter 32 mm
- Baubreite 71 mm
- Bauhöhe 85,5 mm
- Bautiefe gesamt 58 mm

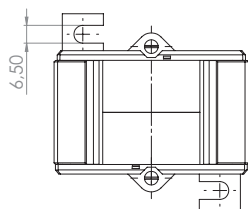
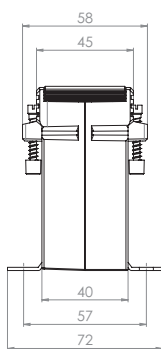
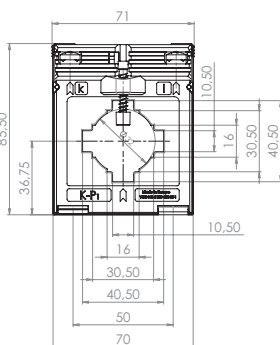

Primärstrom [A]	Bürde [VA]	Sekundärstrom [A] / Klasse			
		5 A Kl. 5P5 Best.-Nr.	5 A Kl. 10P5 Best.-Nr.	1 A Kl. 5P5 Best.-Nr.	1 A Kl. 10P5 Best.-Nr.
100	1	100S24-1306B	100S24-1307B	100S24-1316B	100S24-1317B
120	1	100S24-1406B	100S24-1407B	100S24-1416B	100S24-1417B
125	1	100S24-1506B	100S24-1507B	100S24-1516B	100S24-1517B
150	1	100S24-1606B	100S24-1607B		
	1,5		100S24-1607C	100S24-1616C	100S24-1617C
200	1,5	100S24-1706C	100S24-1707C	100S24-1716C	100S24-1717C
250	1,5	100S24-1806C	100S24-1807C	100S24-1816C	100S24-1817C
	2,5		100S24-1807D	100S24-1816D	100S24-1817D
300	1,5	100S24-1906C	100S24-1907C	100S24-1916C	100S24-1917C
	2,5	100S24-1906D	100S24-1907D	100S24-1916D	100S24-1917D
400	1,5	100S24-2006C	100S24-2007C	100S24-2016C	100S24-2017C
	2,5	100S24-2006D	100S24-2007D	100S24-2016D	100S24-2017D
500	1,5	100S24-2106C	100S24-2107C	100S24-2116C	100S24-2117C
	2,5			100S24-2116D	100S24-2117D
600	1,5	100S24-2206C	100S24-2207C	100S24-2216C	100S24-2217C
	2,5			100S24-2216D	100S24-2217D
750	1,5	100S24-2306C	100S24-2307C	100S24-2316C	100S24-2317C
	2,5		100S24-2307D	100S24-2316D	100S24-2317D

		Best.-Nr.
	Schnappbefestigung Form D	10055012
	Plombierplatte Form B	10059041

SASK 41.6

Schutz-Aufsteck-Stromwandler



- Schiene 1 40 x 12 mm
- Schiene 2 30 x 15 mm
- Rundleiter 32 mm
- Baubreite 95 mm
- Bauhöhe 116 mm
- Bautiefe gesamt 74 mm

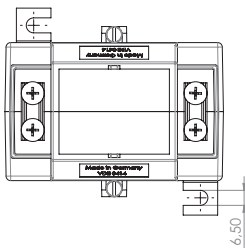
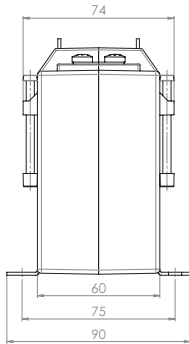
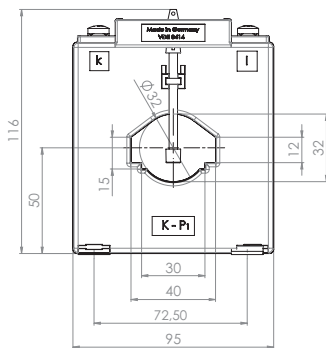

Primärstrom [A]	Bürde [VA]	Sekundärstrom [A] / Klasse			
		5 A Kl. 5P5 Best.-Nr.	5 A Kl. 10P5 Best.-Nr.	5 A Kl. 5P10 Best.-Nr.	5 A Kl. 10P10 Best.-Nr.
75	1,5	100S30-1106C	100S30-1107C	100S30-1108C	100S30-1109C
	2,5	100S30-1106D	100S30-1107D		
100	1,5	100S30-1306C	100S30-1307C	100S30-1308C	100S30-1309C
	2,5	100S30-1306D	100S30-1307D	100S30-1308D	100S30-1309D
	5	100S30-1306F	100S30-1307F		
150	2,5	100S30-1606D	100S30-1607D	100S30-1608D	100S30-1609D
	5	100S30-1606F	100S30-1607F		
200	2,5	100S30-1706D	100S30-1707D	100S30-1708D	100S30-1709D
	5	100S30-1706F	100S30-1707F		100S30-1709F
	7,5	100S30-1706G	100S30-1707G		
	10	100S30-1706H	100S30-1707H		
250	2,5	100S30-1806D	100S30-1807D	100S30-1808D	100S30-1809D
	5	100S30-1806F	100S30-1807F	100S30-1808F	100S30-1809F
	7,5	100S30-1806G	100S30-1807G		
	10	100S30-1806H	100S30-1807H		
300	2,5	100S30-1906D	100S30-1907D	100S30-1908D	100S30-1909D
	5	100S30-1906F	100S30-1907F	100S30-1908F	100S30-1909F
	7,5	100S30-1906G	100S30-1907G		
	10	100S30-1906H	100S30-1907H		
	15		100S30-1906J		
400	2,5	100S30-2006D	100S30-2007D	100S30-2008D	100S30-2009D
	5	100S30-2006F	100S30-2007F	100S30-2008F	100S30-2009F
	7,5	100S30-2006G	100S30-2007G	100S30-2008G	100S30-2009G
	10	100S30-2006H	100S30-2007H		
	15	100S30-2006J	100S30-2007J		
500	2,5	100S30-2106D	100S30-2107D	100S30-2108D	100S30-2109D
	5	100S30-2106F	100S30-2107F	100S30-2108F	100S30-2109F
	7,5	100S30-2106G	100S30-2107G	100S30-2108G	100S30-2109G
	10	100S30-2106H	100S30-2107H	100S30-2108H	100S30-2109H
	15	100S30-2106J	100S30-2107J		
600	2,5	100S30-2206D	100S30-2207D	100S30-2208D	100S30-2209D
	5	100S30-2206F	100S30-2207F	100S30-2208F	100S30-2209F
	7,5	100S30-2206G	100S30-2207G	100S30-2208G	100S30-2209G
	10	100S30-2206H	100S30-2207H	100S30-2208H	100S30-2209H
	15	100S30-2206J	100S30-2207J		
750	2,5	100S30-2306D	100S30-2307D	100S30-2308D	100S30-2309D
	5	100S30-2306F	100S30-2307F	100S30-2308F	100S30-2309F
	7,5	100S30-2306G	100S30-2307G	100S30-2308G	100S30-2309G
	10	100S30-2306H	100S30-2307H	100S30-2308H	100S30-2309H
	15	100S30-2306J	100S30-2307J		

		Best.-Nr.
	Schnappbefestigung	-
	Plombierplatte Form E	10059044

SASK 41.6

Schutz-Aufsteck-Stromwandler



- Schiene 1 40 x 12 mm
- Schiene 2 30 x 15 mm
- Rundleiter 32 mm
- Baubreite 95 mm
- Bauhöhe 116 mm
- Bautiefe gesamt 74 mm

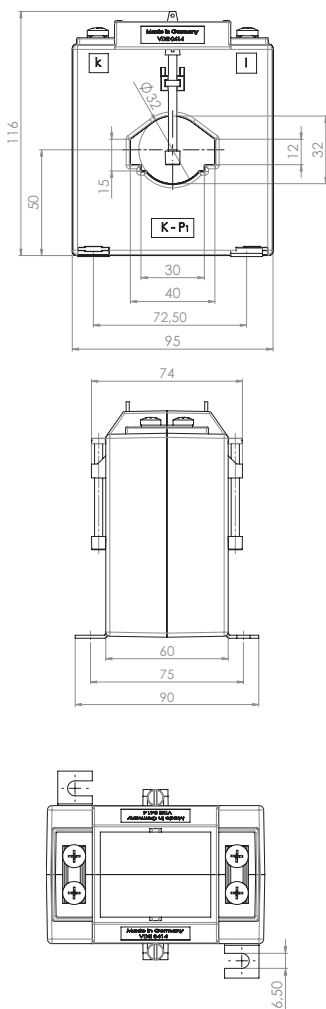

Primärstrom [A]	Bürde [VA]	Sekundärstrom [A] / Klasse			
		1 A Kl. 5P5 Best.-Nr.	1 A Kl. 10P5 Best.-Nr.	1 A Kl. 5P10 Best.-Nr.	1 A Kl. 10P10 Best.-Nr.
75	1,5	100S30-1116C	100S30-1117C	100S30-1118C	100S30-1119C
	2,5	100S30-1116D	100S30-1117D		
100	1,5	100S30-1316C	100S30-1317C	100S30-1318C	100S30-1319C
	2,5	100S30-1316D	100S30-1317D	100S30-1318D	100S30-1319D
	5	100S30-1316F	100S30-1317F		
150	2,5	100S30-1616D	100S30-1617D	100S30-1618D	100S30-1619D
	5	100S30-1616F			
	7,5		100S30-1617G		
200	2,5	100S30-1716D		100S30-1718D	100S30-1719D
	5	100S30-1716F	100S30-1717F		100S30-1719F
	7,5	100S30-1716G	100S30-1717G		
	10	100S30-1716H	100S30-1717H		
250	2,5	100S30-1816D	100S30-1817D	100S30-1818D	100S30-1819D
	5	100S30-1816F	100S30-1817F	100S30-1818F	100S30-1819F
	7,5	100S30-1816G	100S30-1817G		
	10	100S30-1816H	100S30-1817H		
300	2,5	100S30-1916D	100S30-1917D	100S30-1918D	100S30-1919D
	5	100S30-1916F	100S30-1917F	100S30-1918F	100S30-1919F
	7,5	100S30-1916G	100S30-1917G		
	10	100S30-1916H	100S30-1917H		
	15		100S30-1916J		
400	2,5	100S30-2016D	100S30-2017D	100S30-2018D	100S30-2019D
	5	100S30-2016F	100S30-2017F	100S30-2018F	100S30-2019F
	7,5	100S30-2016G	100S30-2017G	100S30-2018G	100S30-2019G
	10	100S30-2016H	100S30-2017H		
	15	100S30-2016J	100S30-2017J		
500	2,5	100S30-2116D	100S30-2117D	100S30-2118D	100S30-2119D
	5	100S30-2116F	100S30-2117F	100S30-2118F	100S30-2119F
	7,5	100S30-2116G	100S30-2117G	100S30-2118G	100S30-2119G
	10	100S30-2116H	100S30-2117H	100S30-2118H	100S30-2119H
	15	100S30-2116J	100S30-2117J		
600	2,5	100S30-2216D	100S30-2217D	100S30-2218D	100S30-2219D
	5	100S30-2216F	100S30-2217F	100S30-2218F	100S30-2219F
	7,5	100S30-2216G	100S30-2217G	100S30-2218G	100S30-2219G
	10	100S30-2216H	100S30-2217H	100S30-2218H	100S30-2219H
	15	100S30-2216J	100S30-2217J		
750	2,5	100S30-2316D	100S30-2317D	100S30-2318D	100S30-2319D
	5	100S30-2316F	100S30-2317F	100S30-2318F	100S30-2319F
	7,5	100S30-2316G	100S30-2317G	100S30-2318G	100S30-2319G
	10	100S30-2316H	100S30-2317H	100S30-2318H	100S30-2319H
	15	100S30-2316J	100S30-2317J		

		Best.-Nr.
	Schnappbefestigung	-
	Plombierplatte Form E	10059044

SASK 41.10

Schutz-Aufsteck-Stromwandler



Schiene 1 40 x 10 mm
 Rundleiter 32 mm
 Baubreite 150 mm
 Bauhöhe 175,5 mm
 Bautiefe gesamt 114 mm

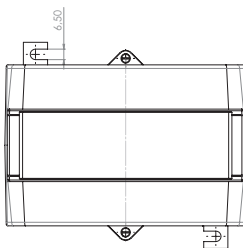
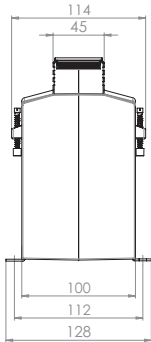
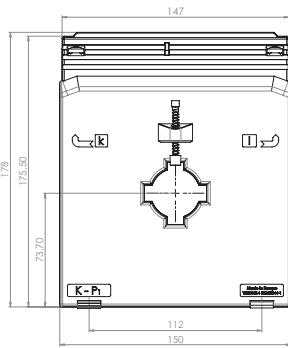

Primärstrom [A]	Bürde [VA]	Sekundärstrom [A] / Klasse			
		5 A Kl. 5P5 Best.-Nr.	5 A Kl. 10P5 Best.-Nr.	5 A Kl. 5P10 Best.-Nr.	5 A Kl. 10P10 Best.-Nr.
75	2,5	100S31-1106D	100S31-1107D		
	5		100S31-1107F		
100	5	100S31-1306F	100S31-1307F	100S31-1308F	100S31-1309F
	7,5	100S31-1306G	100S31-1307G		
	10		100S31-1307H		
150	5	100S31-1606F	100S31-1607F	100S31-1608F	100S31-1609F
	7,5	100S31-1606G	100S31-1607G	100S31-1608G	100S31-1609G
	10	100S31-1606H	100S31-1607H		
	15	100S31-1606J	100S31-1607J		
200	5	100S31-1706F	100S31-1707F	100S31-1708F	100S31-1709F
	7,5	100S31-1706G	100S31-1707G	100S31-1708G	100S31-1709G
	10	100S31-1706H	100S31-1707H	100S31-1708H	100S31-1709H
	15	100S31-1706J	100S31-1707J		
250	5	100S31-1806F	100S31-1807F	100S31-1808F	100S31-1809F
	7,5	100S31-1806G	100S31-1807G	100S31-1808G	100S31-1809G
	10	100S31-1806H	100S31-1807H	100S31-1808H	100S31-1809H
	15	100S31-1806J	100S31-1807J		
300	5	100S31-1906F	100S31-1907F	100S31-1908F	100S31-1909F
	7,5	100S31-1906G	100S31-1907G	100S31-1908G	100S31-1909G
	10	100S31-1906H	100S31-1907H	100S31-1908H	100S31-1909H
	15	100S31-1906J	100S31-1907J	100S31-1908J	100S31-1909J
	30	100S31-1906L	100S31-1907L		
400	5	100S31-2006F	100S31-2007F	100S31-2008F	100S31-2009F
	7,5	100S31-2006G	100S31-2007G	100S31-2008G	100S31-2009G
	10	100S31-2006H	100S31-2007H	100S31-2008H	100S31-2009H
	15	100S31-2006J	100S31-2007J	100S31-2008J	100S31-2009J
	30	100S31-2006L	100S31-2007L		
500	5	100S31-2106F	100S31-2107F	100S31-2108F	100S31-2109F
	7,5	100S31-2106G	100S31-2107G	100S31-2108G	100S31-2109G
	10	100S31-2106H	100S31-2107H	100S31-2108H	100S31-2109H
	15	100S31-2106J	100S31-2107J	100S31-2108J	100S31-2109J
	30	100S31-2106L	100S31-2107L		
600	5	100S31-2206F	100S31-2207F	100S31-2208F	100S31-2209F
	7,5	100S31-2206G	100S31-2207G	100S31-2208G	100S31-2209G
	10	100S31-2206H	100S31-2207H	100S31-2208H	100S31-2209H
	15	100S31-2206J	100S31-2207J	100S31-2208J	100S31-2209J
	30	100S31-2206L	100S31-2207L		
750	5	100S31-2306F	100S31-2307F	100S31-2308F	100S31-2309F
	7,5	100S31-2306G	100S31-2307G	100S31-2308G	100S31-2309G
	10	100S31-2306H	100S31-2307H	100S31-2308H	100S31-2309H
	15	100S31-2306J	100S31-2307J	100S31-2308J	100S31-2309J
	30	100S31-2306L	100S31-2307L		
800	5	100S31-2406F	100S31-2407F	100S31-2408F	100S31-2409F
	7,5	100S31-2406G	100S31-2407G	100S31-2408G	100S31-2409G
	10	100S31-2406H	100S31-2407H	100S31-2408H	100S31-2409H
	15	100S31-2406J	100S31-2407J	100S31-2408J	100S31-2409J
	30	100S31-2406L	100S31-2407L		

SASK 41.10

Schutz-Aufsteck-Stromwandler



Schiene 1 40 x 10 mm
 Rundleiter 32 mm
 Baubreite 150 mm
 Bauhöhe 175,5 mm
 Bautiefe gesamt 114 mm

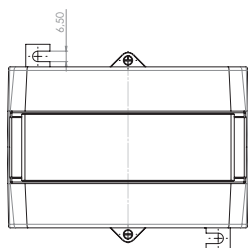
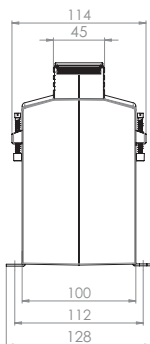
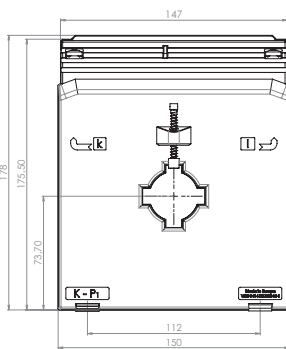

Primärstrom [A]	Bürde [VA]	Sekundärstrom [A] / Klasse			
		5 A Kl. 5P15 Best.-Nr.	5 A Kl. 10P15 Best.-Nr.	5 A Kl. 5P20 Best.-Nr.	5 A Kl. 10P20 Best.-Nr.
100	2,5	100S31-130AD	100S31-130BD		
150	2,5	100S31-160AD	100S31-160BD	100S31-160CD	100S31-160DD
	5	100S31-160AF	100S31-160BF		
200	5	100S31-170AF	100S31-170BF	100S31-170CF	100S31-170DF
250	5	100S31-180AF	100S31-180BF	100S31-180CF	100S31-180DF
300	5	100S31-190AF	100S31-190BF	100S31-190CF	100S31-190DF
	7,5	100S31-190AG	100S31-190BG		
	10	100S31-190AH	100S31-190BH		
400	5	100S31-200AF	100S31-200BF	100S31-200CF	100S31-200DF
	7,5	100S31-200AG	100S31-200BG	100S31-200CG	100S31-200DG
	10	100S31-200AH	100S31-200BH	100S31-200CH	100S31-200DH
500	5	100S31-210AF	100S31-210BF	100S31-210CF	100S31-210DF
	7,5	100S31-210AG	100S31-210BG	100S31-210CG	100S31-210DG
	10	100S31-210AH	100S31-210BH	100S31-210CH	100S31-210DH
	15	100S31-210AJ	100S31-210BJ		
600	5	100S31-220AF	100S31-220BF	100S31-220CF	100S31-220DF
	7,5	100S31-220AG	100S31-220BG	100S31-220CG	100S31-220DG
	10	100S31-220AH	100S31-220BH	100S31-220CH	100S31-220DH
	15	100S31-220AJ	100S31-220BJ		
750	5	100S31-230AF	100S31-230BF	100S31-230CF	100S31-230DF
	7,5	100S31-230AG	100S31-230BG	100S31-230CG	100S31-230DG
	10	100S31-230AH	100S31-230BH	100S31-230CH	100S31-230DH
	15	100S31-230AJ	100S31-230BJ		
800	5	100S31-240AF	100S31-240BF	100S31-240CF	100S31-240DF
	7,5	100S31-240AG	100S31-240BG	100S31-240CG	100S31-240DG
	10	100S31-240AH	100S31-240BH	100S31-240CH	100S31-240DH
	15	100S31-240AJ	100S31-240BJ		

		Best.-Nr.
	Schnappbefestigung	-
	Plombierplatte	-

SASK 41.10

Schutz-Aufsteck-Stromwandler



Schiene 1 40 x 10 mm
 Rundleiter 32 mm
 Baubreite 150 mm
 Bauhöhe 175,5 mm
 Bautiefe gesamt 114 mm

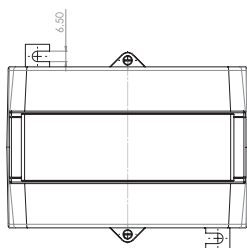
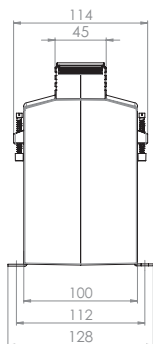
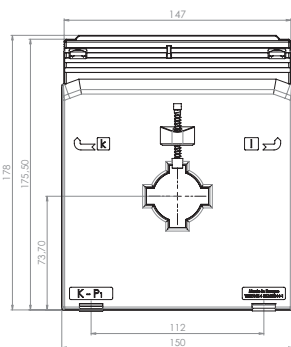

Primärstrom [A]	Bürde [VA]	Sekundärstrom [A] / Klasse			
		1 A Kl. 5P5 Best.-Nr.	1 A Kl. 10P5 Best.-Nr.	1 A Kl. 5P10 Best.-Nr.	1 A Kl. 10P10 Best.-Nr.
75	2,5	100S31-1116D	100S31-1117D		
	5		100S31-1117F		
100	5	100S31-1316F	100S31-1317F	100S31-1318F	100S31-1319F
	7,5	100S31-1316G	100S31-1317G		
	10	100S31-1316H	100S31-1317H		
150	5	100S31-1616F	100S31-1617F	100S31-1618F	100S31-1619F
	7,5	100S31-1616G	100S31-1617G	100S31-1618G	100S31-1619G
	10	100S31-1616H	100S31-1617H		
	15	100S31-1616J	100S31-1617J		
200	5	100S31-1716F	100S31-1717F	100S31-1718F	100S31-1719F
	7,5	100S31-1716G	100S31-1717G	100S31-1718G	100S31-1719G
	10	100S31-1716H	100S31-1717H	100S31-1718H	100S31-1719H
	15	100S31-1716J	100S31-1717J		
250	5	100S31-1816F	100S31-1817F	100S31-1818F	100S31-1819F
	7,5	100S31-1816G	100S31-1817G	100S31-1818G	100S31-1819G
	10	100S31-1816H	100S31-1817H	100S31-1818H	100S31-1819H
	15	100S31-1816J	100S31-1817J		
300	5	100S31-1916F	100S31-1917F	100S31-1918F	100S31-1919F
	7,5	100S31-1916G	100S31-1917G	100S31-1918G	100S31-1919G
	10	100S31-1916H	100S31-1917H	100S31-1918H	100S31-1919H
	15	100S31-1916J	100S31-1917J	100S31-1918J	100S31-1919J
	30	100S31-1916L	100S31-1917L		
400	5	100S31-2016F	100S31-2017F	100S31-2018F	100S31-2019F
	7,5	100S31-2016G	100S31-2017G	100S31-2018G	100S31-2019G
	10	100S31-2016H	100S31-2017H	100S31-2018H	100S31-2019H
	15	100S31-2016J	100S31-2017J	100S31-2018J	100S31-2019J
	30	100S31-2016L	100S31-2017L		
500	5	100S31-2116F	100S31-2117F	100S31-2118F	100S31-2119F
	7,5	100S31-2116G	100S31-2117G	100S31-2118G	100S31-2119G
	10	100S31-2116H	100S31-2117H	100S31-2118H	100S31-2119H
	15	100S31-2116J	100S31-2117J	100S31-2118J	100S31-2119J
	30	100S31-2116L	100S31-2117L		
600	5	100S31-2216F	100S31-2217F	100S31-2218F	100S31-2219F
	7,5	100S31-2216G	100S31-2217G	100S31-2218G	100S31-2219G
	10	100S31-2216H	100S31-2217H	100S31-2218H	100S31-2219H
	15	100S31-2216J	100S31-2217J	100S31-2218J	100S31-2219J
	30	100S31-2216L	100S31-2217L		
750	5	100S31-2316F	100S31-2317F	100S31-2318F	100S31-2319F
	7,5	100S31-2316G	100S31-2317G	100S31-2318G	100S31-2319G
	10	100S31-2316H	100S31-2317H	100S31-2318H	100S31-2319H
	15	100S31-2316J	100S31-2317J	100S31-2318J	100S31-2319J
	30	100S31-2316L	100S31-2317L		
800	5	100S31-2416F	100S31-2417F	100S31-2418F	100S31-2419F
	7,5	100S31-2416G	100S31-2417G	100S31-2418G	100S31-2419G
	10	100S31-2416H	100S31-2417H	100S31-2418H	100S31-2419H
	15	100S31-2416J	100S31-2417J	100S31-2418J	100S31-2419J
	30	100S31-2416L	100S31-2417L		

SASK 41.10

Schutz-Aufsteck-Stromwandler



Schiene 1 40 x 10 mm
 Rundleiter 32 mm
 Baubreite 150 mm
 Bauhöhe 175,5 mm
 Bautiefe gesamt 114 mm

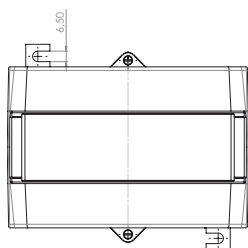
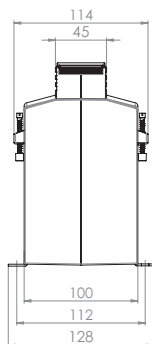
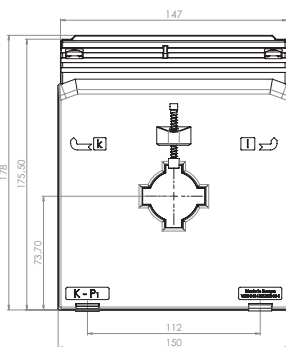

Primärstrom [A]	Bürde [VA]	Sekundärstrom [A] / Klasse			
		1 A Kl. 5P15 Best.-Nr.	1 A Kl. 10P15 Best.-Nr.	1 A Kl. 5P20 Best.-Nr.	1 A Kl. 10P20 Best.-Nr.
100	2,5	100S31-131AD	100S31-131BD		
150	2,5	100S31-161AD	100S31-161BD	100S31-161CD	100S31-161DD
	5	100S31-161AF	100S31-161BF		
200	5	100S31-171AF	100S31-171BF	100S31-171CF	100S31-171DF
250	5	100S31-181AF	100S31-181BF	100S31-181CF	100S31-181DF
300	5	100S31-191AF	100S31-191BF	100S31-191CF	100S31-191DF
	7,5	100S31-191AG	100S31-191BG		
	10	100S31-191AH	100S31-191BH		
400	5	100S31-201AF	100S31-201BF	100S31-201CF	100S31-201DF
	7,5	100S31-201AG	100S31-201BG	100S31-201CG	100S31-201DG
	10	100S31-201AH	100S31-201BH	100S31-201CH	100S31-201DH
500	5	100S31-211AF	100S31-211BF	100S31-211CF	100S31-211DF
	7,5	100S31-211AG	100S31-211BG	100S31-211CG	100S31-211DG
	10	100S31-211AH	100S31-211BH	100S31-211CH	100S31-211DH
	15	100S31-211AJ	100S31-211BJ		
600	5	100S31-221AF	100S31-221BF	100S31-221CF	100S31-221DF
	7,5	100S31-221AG	100S31-221BG	100S31-221CG	100S31-221DG
	10	100S31-221AH	100S31-221BH	100S31-221CH	100S31-221DH
	15	100S31-221AJ	100S31-221BJ		
750	5	100S31-231AF	100S31-231BF	100S31-231CF	100S31-231DF
	7,5	100S31-231AG	100S31-231BG	100S31-231CG	100S31-231DG
	10	100S31-231AH	100S31-231BH	100S31-231CH	100S31-231DH
	15	100S31-231AJ	100S31-231BJ		
800	5	100S31-241AF	100S31-241BF	100S31-241CF	100S31-241DF
	7,5	100S31-241AG	100S31-241BG	100S31-241CG	100S31-241DG
	10	100S31-241AH	100S31-241BH	100S31-241CH	100S31-241DH
	15	100S31-241AJ	100S31-241BJ		

		Best.-Nr.
	Schnappbefestigung	-
	Plombierplatte	-

SASK 541.4

Schutz-Aufsteck-Stromwandler



- Schiene 1 40 x 10 mm
- Schiene 2 2 x 30 x 5 mm
- Rundleiter 32 mm
- Baubreite 86 mm
- Bauhöhe 98,5 mm
- Bautiefe gesamt 58 mm

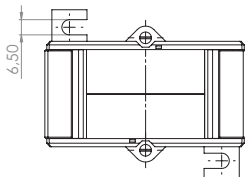
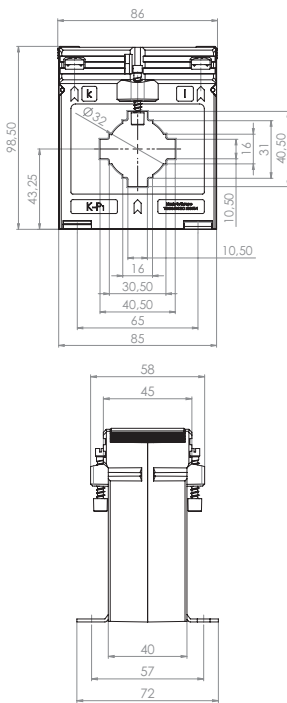

Primärstrom [A]	Bürde [VA]	Sekundärstrom [A] / Klasse			
		5 A Kl. 5P5 Best.-Nr.	5 A Kl. 10P5 Best.-Nr.	5 A Kl. 5P10 Best.-Nr.	5 A Kl. 10P10 Best.-Nr.
100	1	100S33-1306B	100S33-1307B		
	1,5	100S33-1306C	100S33-1307C		
125	1	100S33-1506B	100S33-1507B		
	1,5	100S33-1506C	100S33-1507C		
	2,5		100S33-1507D		
150	1,5	100S33-1606C	100S33-1607C		
	2,5	100S33-1606D	100S33-1607D		
200	1,5	100S33-1706C	100S33-1707C		
	2,5	100S33-1706D	100S33-1707D		
250	1,5	100S33-1806C	100S33-1807C		100S33-1809C
	2,5	100S33-1806D	100S33-1807D		
	1,5	100S33-1906C	100S33-1907C	100S33-1908C	100S33-1909C
300	2,5	100S33-1906D	100S33-1907D		
	5		100S33-1907F		
	1,5	100S33-2006C	100S33-2007C	100S33-2008C	100S33-2009C
400	2,5	100S33-2006D	100S33-2007D		
	5	100S33-2006F	100S33-2007F		
	1,5	100S33-2106C	100S33-2107C	100S33-2108C	100S33-2109C
500	2,5	100S33-2106D	100S33-2107D	100S33-2108D	100S33-2109D
	5	100S33-2106F	100S33-2107F		
	7,5		100S33-2107G		
600	1,5	100S33-2206C	100S33-2207C	100S33-2208C	100S33-2209C
	2,5	100S33-2206D	100S33-2207D	100S33-2208D	100S33-2209D
	5	100S33-2206F	100S33-2207F		
750	7,5		100S33-2207G		
	2,5	100S33-2306D	100S33-2307D	100S33-2308D	100S33-2309D
	5	100S33-2306F	100S33-2307F		
1000	7,5	100S33-2306G	100S33-2307G		
	10	100S33-2306H	100S33-2307H		
	2,5	100S33-2506D	100S33-2507D	100S33-2508D	100S33-2509D
1000	5	100S33-2506F	100S33-2507F		
	7,5	100S33-2506G	100S33-2507G		
	10	100S33-2506H	100S33-2507H		

		Best.-Nr.
	Schnappbefestigung	-
	Plombierplatte Form C	10059042

SASK 541.4

Schutz-Aufsteck-Stromwandler



- Schiene 1 40 x 10 mm
- Schiene 2 2 x 30 x 5 mm
- Rundleiter 32 mm
- Baubreite 86 mm
- Bauhöhe 98,5 mm
- Bautiefe gesamt 58 mm

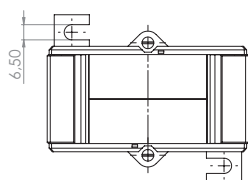
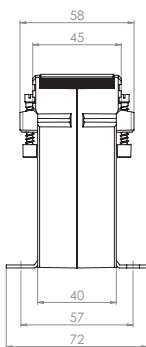
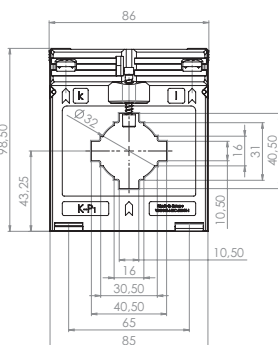

Primärstrom [A]	Bürde [VA]	Sekundärstrom [A] / Klasse			
		1 A Kl. 5P5 Best.-Nr.	1 A Kl. 10P5 Best.-Nr.	1 A Kl. 5P10 Best.-Nr.	1 A Kl. 10P10 Best.-Nr.
100	1	100S33-1316B	100S33-1317B		
	1,5	100S33-1316C	100S33-1317C		
125	1	100S33-1516B	100S33-1517B		
	1,5	100S33-1516C	100S33-1517C		
	2,5	100S33-1516D	100S33-1517D		
150	1,5	100S33-1616C	100S33-1617C		
	2,5	100S33-1616D	100S33-1617D		
200	1,5	100S33-1716C	100S33-1717C		
	2,5	100S33-1716D	100S33-1717D		
250	1,5	100S33-1816C	100S33-1817C	100S33-1818C	100S33-1819C
	2,5	100S33-1816D	100S33-1817D		
300	1,5	100S33-1916C	100S33-1917C	100S33-1918C	100S33-1919C
	2,5	100S33-1916D	100S33-1917D		
	5		100S33-1917F		
400	1,5	100S33-2016C	100S33-2017C	100S33-2018C	100S33-2019C
	2,5	100S33-2016D	100S33-2017D		
	5	100S33-2016F	100S33-2017F		
500	1,5	100S33-2116C	100S33-2117C	100S33-2118C	100S33-2119C
	2,5	100S33-2116D	100S33-2117D	100S33-2118D	100S33-2119D
	5	100S33-2116F	100S33-2117F		
600	1,5	100S33-2216C	100S33-2217C	100S33-2218C	100S33-2219C
	2,5	100S33-2216D	100S33-2217D	100S33-2218D	100S33-2219D
	5	100S33-2216F	100S33-2217F		
	7,5		100S33-2217G		
750	1,5	100S33-2316C	100S33-2317C	100S33-2318C	100S33-2319C
	2,5	100S33-2316D	100S33-2317D	100S33-2318D	100S33-2319D
	5	100S33-2316F	100S33-2317F		
	7,5	100S33-2316G	100S33-2317G		
	10	100S33-2316H	100S33-2317H		
1000	2,5	100S33-2516D	100S33-2517D	100S33-2518D	100S33-2519D
	5	100S33-2516F	100S33-2517F		100S33-2519F
	7,5	100S33-2516G	100S33-2517G		
	10	100S33-2516H	100S33-2517H		

		Best.-Nr.
	Schnappbefestigung	-
	Plombierplatte Form C	10059042

SASK 51.4

Schutz-Aufsteck-Stromwandler



- Schiene 1 50 x 12 mm
- Schiene 2 2 x 40 x 10 mm
- Rundleiter 44 mm
- Baubreite 86 mm
- Bauhöhe 98,5 mm
- Bautiefe gesamt 58 mm

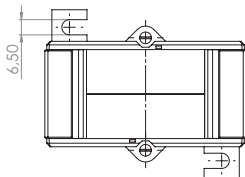
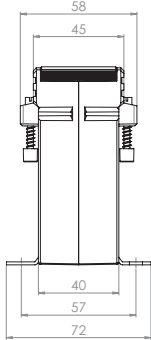
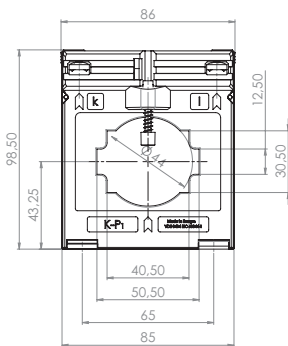

Primärstrom [A]	Bürde [VA]	Sekundärstrom [A] / Klasse			
		5 A Kl. 5P5 Best.-Nr.	5 A Kl. 10P5 Best.-Nr.	1 A Kl. 5P5 Best.-Nr.	1 A Kl. 10P5 Best.-Nr.
150	1			100S34-1616B	100S34-1617B
200	1	100S34-1706B	100S34-1707B	100S34-1716B	100S34-1717B
	1,5		100S34-1707C	100S34-1716C	100S34-1717C
250	1,5	100S34-1806C	100S34-1807C	100S34-1816C	100S34-1817C
	2,5				100S34-1817D
300	1,5	100S34-1906C	100S34-1907C	100S34-1916C	100S34-1917C
	2,5			100S34-1916D	100S34-1917D
400	1,5	100S34-2006C	100S34-2007C	100S34-2016C	100S34-2017C
	2,5		100S34-2007D	100S34-2016D	100S34-2017D
500	1,5	100S34-2106C	100S34-2107C	100S34-2116C	100S34-2117C
	2,5		100S34-2107D	100S34-2116D	100S34-2117D
600	1,5	100S34-2206C	100S34-2207C	100S34-2216C	100S34-2217C
	2,5		100S34-2207D	100S34-2216D	100S34-2217D
750	1,5	100S34-2306C	100S34-2307C	100S34-2316C	100S34-2317C
	2,5	100S34-2306D	100S34-2307D	100S34-2316D	100S34-2317D
1000	1,5	100S34-2506C	100S34-2507C	100S34-2516C	100S34-2517C
	2,5	100S34-2506D	100S34-2507D	100S34-2516D	100S34-2517D

		Best.-Nr.
	Schnappbefestigung	-
	Plombierplatte Form C	10059042

SASK 51.6

Schutz-Aufsteck-Stromwandler



- Schiene 1 50 x 12 mm
- Schiene 2 40 x 30 mm
- Rundleiter 40 mm
- Baubreite 95 mm
- Bauhöhe 116 mm
- Bautiefe gesamt 74 mm

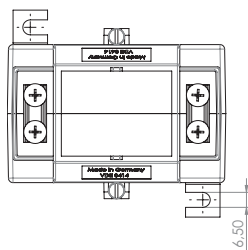
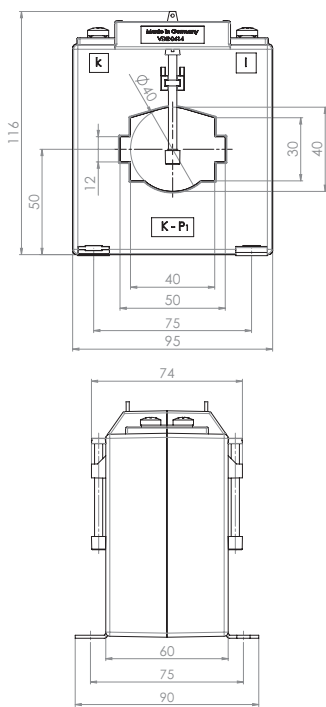

Primärstrom [A]	Bürde [VA]	Sekundärstrom [A] / Klasse			
		5 A Kl. 5P5 Best.-Nr.	5 A Kl. 10P5 Best.-Nr.	5 A Kl. 5P10 Best.-Nr.	5 A Kl. 10P10 Best.-Nr.
150	1,5	100S37-1606C	100S37-1607C	100S37-1608C	100S37-1609C
	2,5	100S37-1606D	100S37-1607D		100S37-1609D
	5	100S37-1606F	100S37-1607F		
200	1,5	100S37-1706C	100S37-1707C	100S37-1708C	100S37-1709C
	2,5	100S37-1706D	100S37-1707D	100S37-1708D	100S37-1709D
	5	100S37-1706F	100S37-1707F		
250	2,5	100S37-1806D	100S37-1807D	100S37-1808D	100S37-1809D
	5	100S37-1806F	100S37-1807F		
	7,5		100S37-1807G		
300	2,5	100S37-1906D	100S37-1907D	100S37-1908D	100S37-1909D
	5	100S37-1906F	100S37-1907F		
	7,5	100S37-1906G	100S37-1907G		
	10		100S37-1907H		
400	2,5	100S37-2006D	100S37-2007D	100S37-2008D	100S37-2009D
	5	100S37-2006F	100S37-2007F	100S37-2008F	100S37-2009F
	7,5	100S37-2006G	100S37-2007G		
	10	100S37-2006H	100S37-2007H		
500	2,5	100S37-2106D	100S37-2107D	100S37-2108D	100S37-2109D
	5	100S37-2106F	100S37-2107F	100S37-2108F	100S37-2109F
	7,5	100S37-2106G	100S37-2107G		
	10	100S37-2106H	100S37-2107H		
600	15		100S37-2107J		
	2,5	100S37-2206D	100S37-2207D	100S37-2208D	100S37-2209D
	5	100S37-2206F	100S37-2207F	100S37-2208F	100S37-2209F
	7,5	100S37-2206G	100S37-2207G		
	10	100S37-2206H	100S37-2207H		
750	15	100S37-2206J	100S37-2207J		
	2,5	100S37-2306D	100S37-2307D	100S37-2308D	100S37-2309D
	5	100S37-2306F	100S37-2307F	100S37-2308F	100S37-2309F
	7,5	100S37-2306G	100S37-2307G	100S37-2308G	100S37-2309G
1000	10	100S37-2306H	100S37-2307H		
	15	100S37-2306J	100S37-2307J		
	2,5	100S37-2506D	100S37-2507D	100S37-2508D	100S37-2509D
	5	100S37-2506F	100S37-2507F	100S37-2508F	100S37-2509F
	7,5	100S37-2506G	100S37-2507G	100S37-2508G	100S37-2509G
1000	10	100S37-2506H	100S37-2507H		
	15	100S37-2506J	100S37-2507J		

		Best.-Nr.
	Schnappbefestigung	-
	Plombierplatte Form E	10059044

SASK 51.6

Schutz-Aufsteck-Stromwandler



- Schiene 1 50 x 12 mm
- Schiene 2 40 x 30 mm
- Rundleiter 40 mm
- Baubreite 95 mm
- Bauhöhe 116 mm
- Bautiefe gesamt 74 mm

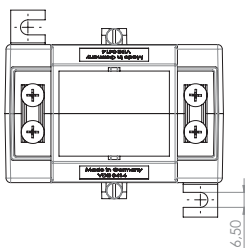
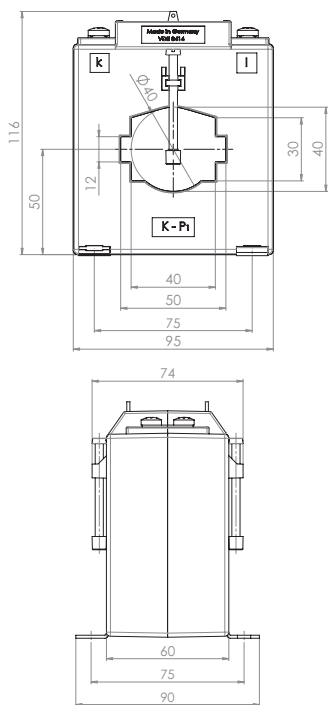

Primärstrom [A]	Bürde [VA]	Sekundärstrom [A] / Klasse			
		1 A Kl. 5P5 Best.-Nr.	1 A Kl. 10P5 Best.-Nr.	1 A Kl. 5P10 Best.-Nr.	1 A Kl. 10P10 Best.-Nr.
150	1,5	100S37-1616C	100S37-1617C	100S37-1618C	100S37-1619C
	2,5	100S37-1616D	100S37-1617D		100S37-1619D
	5	100S37-1616F	100S37-1617F		
200	1,5	100S37-1716C	100S37-1717C	100S37-1718C	100S37-1719C
	2,5	100S37-1716D	100S37-1717D	100S37-1718D	100S37-1719D
	5	100S37-1716F	100S37-1717F		
250	2,5	100S37-1816D	100S37-1817D	100S37-1818D	100S37-1819D
	5	100S37-1816F	100S37-1817F		
	7,5		100S37-1817G		
300	2,5	100S37-1916D	100S37-1917D	100S37-1918D	100S37-1919D
	5	100S37-1916F	100S37-1917F		
	7,5		100S37-1917G		
400	10		100S37-1917H		
	2,5	100S37-2016D	100S37-2017D	100S37-2018D	100S37-2019D
	5	100S37-2016F	100S37-2017F	100S37-2018F	100S37-2019F
	7,5	100S37-2016G	100S37-2017G		
500	10	100S37-2016H	100S37-2017H		
	2,5	100S37-2116D	100S37-2117D	100S37-2118D	100S37-2119D
	5	100S37-2116F	100S37-2117F	100S37-2118F	100S37-2119F
	7,5	100S37-2116G	100S37-2117G		
600	10	100S37-2116H	100S37-2117H		
	15		100S37-2117J		
	2,5	100S37-2216D	100S37-2217D	100S37-2218D	100S37-2219D
	5	100S37-2216F	100S37-2217F	100S37-2218F	100S37-2219F
750	7,5	100S37-2216G	100S37-2217G		
	10	100S37-2216H	100S37-2217H		
	15	100S37-2216J	100S37-2217J		
	2,5	100S37-2316D	100S37-2317D	100S37-2318D	100S37-2319D
1000	5	100S37-2316F	100S37-2317F	100S37-2318F	100S37-2319F
	7,5	100S37-2316G	100S37-2317G		
	10	100S37-2316H	100S37-2317H		
	15	100S37-2316J	100S37-2317J		
1000	2,5	100S37-2516D	100S37-2517D	100S37-2518D	100S37-2519D
	5	100S37-2516F	100S37-2517F	100S37-2518F	100S37-2519F
	7,5	100S37-2516G	100S37-2517G	100S37-2518G	100S37-2519G
	10	100S37-2516H	100S37-2517H		
	15	100S37-2516J	100S37-2517J		

		Best.-Nr.
	Schnappbefestigung	-
	Plombierplatte Form E	10059044

SASK 61.4

Schutz-Aufsteck-Stromwandler



- Schiene 1 60 x 10 mm
- Schiene 2 2 x 50 x 10 mm
- Rundleiter 44 mm
- Baubreite 96 mm
- Bauhöhe 105,5 mm
- Bautiefe gesamt 58 mm

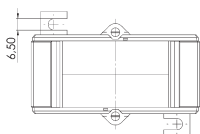
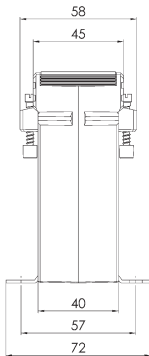
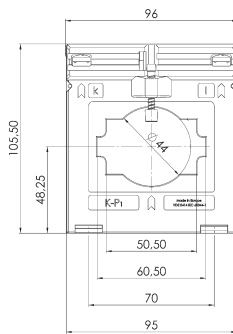

Primärstrom [A]	Bürde [VA]	Sekundärstrom [A] / Klasse			
		5 A Kl. 5P5 Best.-Nr.	5 A Kl. 10P5 Best.-Nr.	1 A Kl. 5P5 Best.-Nr.	1 A Kl. 10P5 Best.-Nr.
200	1	100S41-1706B	100S41-1707B	100S41-1716B	100S41-1717B
	1,5	100S41-1706C	100S41-1707C	100S41-1716C	100S41-1717C
250	1	100S41-1806B	100S41-1807B	100S41-1816B	100S41-1817B
	1,5	100S41-1806C	100S41-1807C	100S41-1816C	100S41-1817C
300	1,5	100S41-1906C	100S41-1907C	100S41-1916C	100S41-1917C
	2,5		100S41-1907D	100S41-1916D	100S41-1917D
400	1,5	100S41-2006C	100S41-2007C	100S41-2016C	100S41-2017C
	2,5	100S41-2006D	100S41-2007D	100S41-2016D	100S41-2017D
500	1,5	100S41-2106C	100S41-2107C	100S41-2116C	100S41-2117C
	2,5	100S41-2106D	100S41-2107D	100S41-2116D	100S41-2117D
600	1,5	100S41-2206C	100S41-2207C	100S41-2216C	100S41-2217C
	2,5	100S41-2206D	100S41-2207D	100S41-2216D	100S41-2217D
	5			100S41-2216F	100S41-2217F
750	1,5	100S41-2306C	100S41-2307C	100S41-2316C	100S41-2317C
	2,5	100S41-2306D	100S41-2307D	100S41-2316D	100S41-2317D
	5	100S41-2307F		100S41-2316F	100S41-2317F
1000	1,5	100S41-2506C	100S41-2507C	100S41-2516C	100S41-2517C
	2,5	100S41-2506D	100S41-2507D	100S41-2516D	100S41-2517D
	5	100S41-2506F	100S41-2507F	100S41-2516F	100S41-2517F
1200	1,5	100S41-2606C	100S41-2607C	100S41-2616C	100S41-2617C
	2,5	100S41-2606D	100S41-2607D	100S41-2616D	100S41-2617D
	5	100S41-2606F	100S41-2607F	100S41-2616F	100S41-2617F
1250	1,5	100S41-2706C	100S41-2707C	100S41-2716C	100S41-2717C
	2,5	100S41-2706D	100S41-2707D	100S41-2716D	100S41-2717D
	5	100S41-2706F	100S41-2707F	100S41-2716F	100S41-2717F

		Best.-Nr.
	Schnappbefestigung	-
	Plombierplatte Form C	10059042

SASK 61.10

Schutz-Aufsteck-Stromwandler



- Schiene 1 60 x 10 mm
- Schiene 2 50 x 30 mm
- Baubreite 150 mm
- Bauhöhe 175,5 mm
- Bautiefe gesamt 114 mm

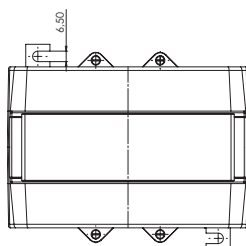
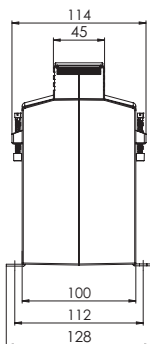
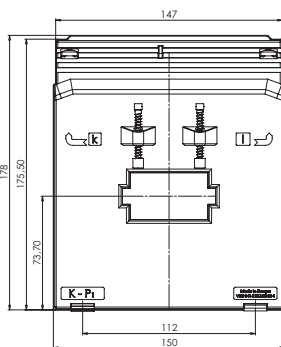

Primärstrom [A]	Bürde [VA]	Sekundärstrom [A] / Klasse			
		5 A Kl. 5P5 Best.-Nr.	5 A Kl. 10P5 Best.-Nr.	5 A Kl. 5P10 Best.-Nr.	5 A Kl. 10P10 Best.-Nr.
100	2,5	100S50-1306D	100S50-1307D	100S50-1308D	100S50-1309D
	5	100S50-1306F	100S50-1307F		
150	5	100S50-1606F	100S50-1607F	100S50-1608F	100S50-1609F
	7,5	100S50-1606G	100S50-1607G		
	10	100S50-1606H	100S50-1607H		
200	5	100S50-1706F	100S50-1707F	100S50-1708F	100S50-1709F
	7,5	100S50-1706G	100S50-1707G		
	10	100S50-1706H	100S50-1707H		
	15	100S50-1706J	100S50-1707J		
250	5	100S50-1806F	100S50-1807F	100S50-1808F	100S50-1809F
	7,5	100S50-1806G	100S50-1807G		100S50-1809G
	10	100S50-1806H	100S50-1807H	100S50-1908H	100S50-1809H
	15	100S50-1806J	100S50-1807J		
300	5	100S50-1906F	100S50-1907F	100S50-1908F	100S50-1909F
	7,5	100S50-1906G	100S50-1907G	100S50-1908G	100S50-1909G
	10	100S50-1906H	100S50-1907H		100S50-1909H
	15	100S50-1906J	100S50-1907J		
400	5	100S50-2006F	100S50-2007F	100S50-2008F	100S50-2009F
	7,5	100S50-2006G	100S50-2007G	100S50-2008G	100S50-2009G
	10	100S50-2006H	100S50-2007H	100S50-2008H	100S50-2009H
	15	100S50-2006J	100S50-2007J		100S50-2009J
500	5	100S50-2106F	100S50-2107F	100S50-2108F	100S50-2109F
	7,5	100S50-2106G	100S50-2107G	100S50-2108G	100S50-2109G
	10	100S50-2106H	100S50-2107H	100S50-2108H	100S50-2109H
	15	100S50-2106J	100S50-2107J	100S50-2108J	100S50-2109J
600	5	100S50-2206F	100S50-2207F	100S50-2208F	100S50-2209F
	7,5	100S50-2206G	100S50-2207G	100S50-2208G	100S50-2209G
	10	100S50-2206H	100S50-2207H	100S50-2208H	100S50-2209H
	15	100S50-2206J	100S50-2207J	100S50-2208J	100S50-2209J
750	5	100S50-2306F	100S50-2307F	100S50-2308F	100S50-2309F
	7,5	100S50-2306G	100S50-2307G	100S50-2308G	100S50-2309G
	10	100S50-2306H	100S50-2307H	100S50-2308H	100S50-2309H
	15	100S50-2306J	100S50-2307J	100S50-2308J	100S50-2309J
1000	5	100S50-2506F	100S50-2507F	100S50-2508F	100S50-2509F
	7,5	100S50-2506G	100S50-2507G	100S50-2508G	100S50-2509G
	10	100S50-2506H	100S50-2507H	100S50-2508H	100S50-2509H
	15	100S50-2506J	100S50-2507J	100S50-2508J	100S50-2509J
1200	5	100S50-2606F	100S50-2607F	100S50-2608F	100S50-2609F
	7,5	100S50-2606G	100S50-2607G	100S50-2608G	100S50-2609G
	10	100S50-2606H	100S50-2607H	100S50-2608H	100S50-2609H
	15	100S50-2606J	100S50-2607J	100S50-2608J	100S50-2609J
1250	5	100S50-2706F	100S50-2707F	100S50-2708F	100S50-2709F
	7,5	100S50-2706G	100S50-2707G	100S50-2708G	100S50-2709G
	10	100S50-2706H	100S50-2707H	100S50-2708H	100S50-2709H
	15	100S50-2706J	100S50-2707J	100S50-2708J	100S50-2709J
1500	5	100S50-2806F	100S50-2807F	100S50-2808F	100S50-2809F
	7,5	100S50-2806G	100S50-2807G	100S50-2808G	100S50-2809G
	10	100S50-2806H	100S50-2807H	100S50-2808H	100S50-2809H
	15	100S50-2806J	100S50-2807J	100S50-2808J	100S50-2809J

SASK 61.10

Schutz-Aufsteck-Stromwandler



Schiene 1 60 x 10 mm
 Schiene 2 50 x 30 mm
 Baubreite 150 mm
 Bauhöhe 175,5 mm
 Bautiefe gesamt 114 mm

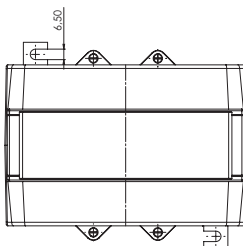
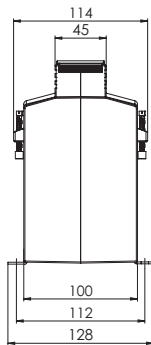
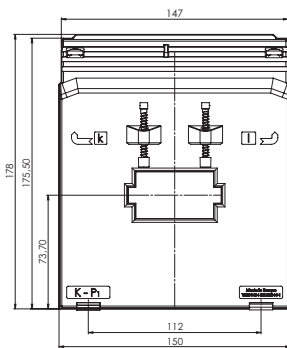

Primärstrom [A]	Bürde [VA]	Sekundärstrom [A] / Klasse			
		5 A Kl. 5P15 Best.-Nr.	5 A Kl. 10P15 Best.-Nr.	5 A Kl. 5P20 Best.-Nr.	5 A Kl. 10P20 Best.-Nr.
150	2,5	100S50-160AD	100S50-160BD		
200	2,5	100S50-170AD	100S50-170BD	100S50-170CD	100S50-170DD
250	2,5	100S50-180AD	100S50-180BD	100S50-180CD	100S50-180DD
	5	100S50-180AF	100S50-180BF		
300	2,5	100S50-190AD	100S50-190BD	100S50-190CD	100S50-190DD
	5	100S50-190AF	100S50-190BF		100S50-190DF
400	5	100S50-200AF	100S50-200BF	100S50-200CF	100S50-200DF
500	5	100S50-210AF	100S50-210BF	100S50-210CF	100S50-210DF
	7,5	100S50-210AG	100S50-210BG		
	10	100S50-210AH	100S50-210BH		
600	5	100S50-220AF	100S50-220BF	100S50-220CF	100S50-220DF
	7,5	100S50-220AG	100S50-220BG		
	10	100S50-220AH	100S50-220BH		
750	5	100S50-230AF	100S50-230BF	100S50-230CF	100S50-230DF
	7,5	100S50-230AG	100S50-230BG		
	10	100S50-230AH	100S50-230BH		
1000	5	100S50-250AF	100S50-250BF	100S50-250CF	100S50-250DF
	7,5	100S50-250AG	100S50-250BG		
	10	100S50-250AH	100S50-250BH		
1200	5	100S50-260AF	100S50-260BF	100S50-260CF	100S50-260DF
	7,5	100S50-260AG	100S50-260BG		
	10	100S50-260AH	100S50-260BH		
1250	5	100S50-270AF	100S50-270BF	100S50-270CF	100S50-270DF
	7,5	100S50-270AG	100S50-270BG		
	10	100S50-270AH	100S50-270BH		
1500	5	100S50-280AF	100S50-280BF	100S50-280CF	100S50-280DF
	7,5	100S50-280AG	100S50-280BG		
	10	100S50-280AH	100S50-280BH		
	15		100S50-280BJ		

		Best.-Nr.
	Schnappbefestigung	-
	Plombierplatte	-

SASK 61.10

Schutz-Aufsteck-Stromwandler



- Schiene 1 60 x 10 mm
- Schiene 2 50 x 30 mm
- Baubreite 150 mm
- Bauhöhe 175,5 mm
- Bautiefe gesamt 114 mm

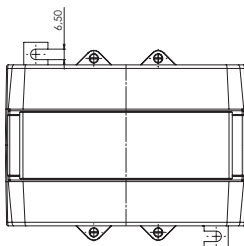
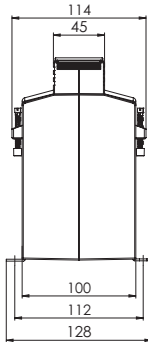
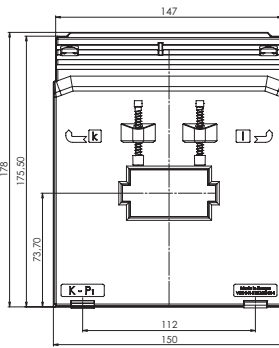

Primärstrom [A]	Bürde [VA]	Sekundärstrom [A] / Klasse			
		1 A Kl. 5P5 Best.-Nr.	1 A Kl. 10P5 Best.-Nr.	1 A Kl. 5P10 Best.-Nr.	1 A Kl. 10P10 Best.-Nr.
100	2,5	100S50-1316D	100S50-1317D	100S50-1318D	100S50-1319D
	5	100S50-1316F	100S50-1317F		
150	5	100S50-1616F	100S50-1617F	100S50-1618F	100S50-1619F
	7,5	100S50-1616G	100S50-1617G		
	10	100S50-1616H	100S50-1617H		
200	5	100S50-1716F	100S50-1717F	100S50-1718F	100S50-1719F
	7,5	100S50-1716G	100S50-1717G		
	10	100S50-1716H	100S50-1717H		
	15	100S50-1716J	100S50-1717J		
250	5	100S50-1816F	100S50-1817F	100S50-1818F	100S50-1819F
	7,5	100S50-1816G	100S50-1817G		100S50-1819G
	10	100S50-1816H	100S50-1817H	100S50-1918H	100S50-1819H
	15	100S50-1816J	100S50-1817J		
300	5	100S50-1916F	100S50-1917F	100S50-1918F	100S50-1919F
	7,5	100S50-1916G	100S50-1917G	100S50-1918G	100S50-1919G
	10	100S50-1916H	100S50-1917H		100S50-1919H
	15	100S50-1916J	100S50-1917J		
400	5	100S50-2016F	100S50-2017F	100S50-2018F	100S50-2019F
	7,5	100S50-2016G	100S50-2017G	100S50-2018G	100S50-2019G
	10	100S50-2016H	100S50-2017H	100S50-2018H	100S50-2019H
	15	100S50-2016J	100S50-2017J		100S50-2019J
500	5	100S50-2116F	100S50-2117F	100S50-2118F	100S50-2119F
	7,5	100S50-2116G	100S50-2117G	100S50-2118G	100S50-2119G
	10	100S50-2116H	100S50-2117H	100S50-2118H	100S50-2119H
	15	100S50-2116J	100S50-2117J	100S50-2118J	100S50-2119J
600	5	100S50-2216F	100S50-2217F	100S50-2218F	100S50-2219F
	7,5	100S50-2216G	100S50-2217G	100S50-2218G	100S50-2219G
	10	100S50-2216H	100S50-2217H	100S50-2218H	100S50-2219H
	15	100S50-2216J	100S50-2217J	100S50-2218J	100S50-2219J
750	5	100S50-2316F	100S50-2317F	100S50-2318F	100S50-2319F
	7,5	100S50-2316G	100S50-2317G	100S50-2318G	100S50-2319G
	10	100S50-2316H	100S50-2317H	100S50-2318H	100S50-2319H
	15	100S50-2316J	100S50-2317J	100S50-2318J	100S50-2319J
1000	5	100S50-2516F	100S50-2517F	100S50-2518F	100S50-2519F
	7,5	100S50-2516G	100S50-2517G	100S50-2518G	100S50-2519G
	10	100S50-2516H	100S50-2517H	100S50-2518H	100S50-2519H
	15	100S50-2516J	100S50-2517J	100S50-2518J	100S50-2519J
1200	5	100S50-2616F	100S50-2617F	100S50-2618F	100S50-2619F
	7,5	100S50-2616G	100S50-2617G	100S50-2618G	100S50-2619G
	10	100S50-2616H	100S50-2617H	100S50-2618H	100S50-2619H
	15	100S50-2616J	100S50-2617J	100S50-2618J	100S50-2619J
1250	5	100S50-2716F	100S50-2717F	100S50-2718F	100S50-2719F
	7,5	100S50-2716G	100S50-2717G	100S50-2718G	100S50-2719G
	10	100S50-2716H	100S50-2717H	100S50-2718H	100S50-2719H
	15	100S50-2716J	100S50-2717J	100S50-2718J	100S50-2719J
1500	5	100S50-2816F	100S50-2817F	100S50-2818F	100S50-2819F
	7,5	100S50-2816G	100S50-2817G	100S50-2818G	100S50-2819G
	10	100S50-2816H	100S50-2817H	100S50-2818H	100S50-2819H
	15	100S50-2816J	100S50-2817J	100S50-2818J	100S50-2819J

SASK 61.10

Schutz-Aufsteck-Stromwandler



Schiene 1 60 x 10 mm
 Schiene 2 50 x 30 mm
 Baubreite 150 mm
 Bauhöhe 175,5 mm
 Bautiefe gesamt 114 mm

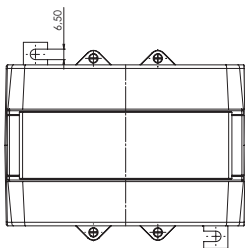
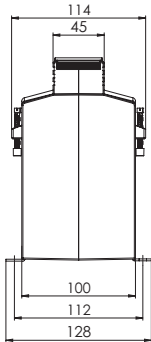
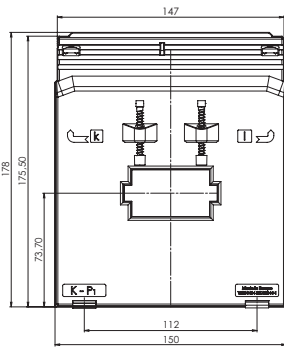

Primärstrom [A]	Bürde [VA]	Sekundärstrom [A] / Klasse			
		1 A Kl. 5P15 Best.-Nr.	1 A Kl. 10P15 Best.-Nr.	1 A Kl. 5P20 Best.-Nr.	1 A Kl. 10P20 Best.-Nr.
150	2,5	100S50-161AD	100S50-161BD		
200	2,5	100S50-171AD	100S50-171BD	100S50-171CD	100S50-171DD
250	2,5	100S50-181AD	100S50-181BD	100S50-181CD	100S50-181DD
	5	100S50-181AF	100S50-181BF		
300	2,5	100S50-191AD	100S50-191BD	100S50-191CD	100S50-191DD
	5	100S50-191AF	100S50-191BF		100S50-191DF
400	5	100S50-201AF	100S50-201BF	100S50-201CF	100S50-201DF
500	5	100S50-211AF	100S50-211BF	100S50-211CF	100S50-211DF
	7,5	100S50-211AG	100S50-211BG		
	10	100S50-211AH	100S50-211BH		
600	5	100S50-221AF	100S50-221BF	100S50-221CF	100S50-221DF
	7,5	100S50-221AG	100S50-221BG		
	10	100S50-221AH	100S50-221BH		
750	5	100S50-231AF	100S50-231BF	100S50-231CF	100S50-231DF
	7,5	100S50-231AG	100S50-231BG		
	10	100S50-231AH	100S50-231BH		
1000	5	100S50-251AF	100S50-251BF	100S50-251CF	100S50-251DF
	7,5	100S50-251AG	100S50-251BG		
	10	100S50-251AH	100S50-251BH		
1200	5	100S50-261AF	100S50-261BF	100S50-261CF	100S50-261DF
	7,5	100S50-261AG	100S50-261BG		
	10	100S50-261AH	100S50-261BH		
1250	5	100S50-271AF	100S50-271BF	100S50-271CF	100S50-271DF
	7,5	100S50-271AG	100S50-271BG		
	10	100S50-271AH	100S50-271BH		
1500	5	100S50-281AF	100S50-281BF	100S50-281CF	100S50-281DF
	7,5	100S50-281AG	100S50-281BG		
	10	100S50-281AH	100S50-281BH		
	15		100S50-281BJ		

		Best.-Nr.
	Schnappbefestigung	-
	Plombierplatte	-

SASK 63.6

Schutz-Aufsteck-Stromwandler



Schiene 1 60 x 30 mm
 Rundleiter 30 mm
 Baubreite 88 mm
 Bauhöhe 129 mm
 Bautiefe gesamt 78 mm

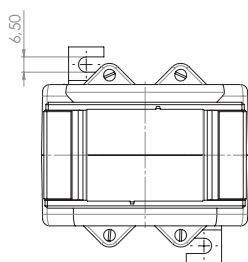
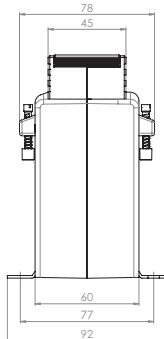
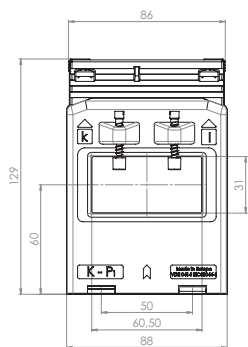

Primärstrom [A]	Bürde [VA]	Sekundärstrom [A] / Klasse			
		5 A Kl. 5P5 Best.-Nr.	5 A Kl. 10P5 Best.-Nr.	1 A Kl. 5P5 Best.-Nr.	1 A Kl. 10P5 Best.-Nr.
200	1,5	100S46-1706C	100S46-1707C	100S46-1716C	100S46-1717C
	2,5		100S46-1707D	100S46-1716D	100S46-1717D
250	1,5	100S46-1806C	100S46-1807C	100S46-1816C	100S46-1817C
	2,5	100S46-1806D	100S46-1807D	100S46-1816D	100S46-1817D
300	1,5	100S46-1906C	100S46-1907C	100S46-1916C	100S46-1917C
	2,5	100S46-1906D	100S46-1907D	100S46-1916D	100S46-1917D
400	2,5	100S46-2006D	100S46-2007D	100S46-2016D	100S46-2017D
	5		100S46-2007F	100S46-2016F	100S46-2017F
500	2,5	100S46-2106D	100S46-2107D	100S46-2116D	100S46-2117D
	5	100S46-2106F	100S46-2107F	100S46-2116F	100S46-2117F
600	2,5	100S46-2206D	100S46-2207D	100S46-2216D	100S46-2217D
	5	100S46-2206F	100S46-2207F	100S46-2216F	100S46-2217F
750	2,5	100S46-2306D	100S46-2307D	100S46-2316D	100S46-2317D
	5	100S46-2306F	100S46-2307F	100S46-2316F	100S46-2317F
1000	2,5	100S46-2506D	100S46-2507D	100S46-2516D	100S46-2517D
	5	100S46-2506F	100S46-2507F	100S46-2516F	100S46-2517F

		Best.-Nr.
	Schnappbefestigung	-
	Plombierplatte Form C	10059042

SASK 105.6

Schutz-Aufsteck-Stromwandler



Schiene 1 100 x 55 mm
 Rundleiter 55 mm
 Baubreite 129 mm
 Bauhöhe 167 mm
 Bautiefe gesamt 78 mm

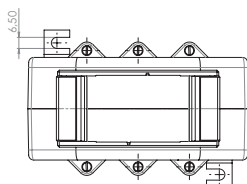
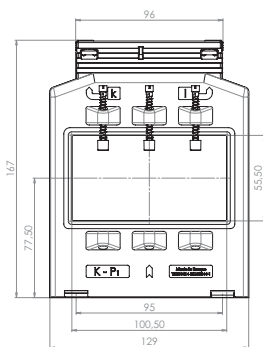

Primärstrom [A]	Bürde [VA]	Sekundärstrom [A] / Klasse			
		5 A Kl. 5P5 Best.-Nr.	5 A Kl. 10P5 Best.-Nr.	5 A Kl. 5P10 Best.-Nr.	5 A Kl. 10P10 Best.-Nr.
600	2,5	100S56-2206C	100S56-2207C	100S56-2208D	100S56-2209D
	5	100S56-2206F	100S56-2207F		100S56-2209F
750	2,5	100S56-2306C	100S56-2307C	100S56-2308D	100S56-2309D
	5	100S56-2306F	100S56-2307F	100S56-2308F	100S56-2309F
	7,5	100S56-2306G	100S56-2307G		
	10	100S56-2306H	100S56-2307H		
1000	5	100S56-2506F	100S56-2507F	100S56-2508F	100S56-2509F
	7,5	100S56-2506G	100S56-2507G	100S56-2508G	100S56-2509G
	10	100S56-2506H	100S56-2507H		
1200	5	100S56-2606F	100S56-2607F	100S56-2608F	100S56-2609F
	7,5	100S56-2606G	100S56-2607G	100S56-2608G	100S56-2609G
	10	100S56-2606H	100S56-2607H		
	15	100S56-2606J	100S56-2607J		
1250	5	100S56-2706F	100S56-2707F	100S56-2708F	100S56-2709F
	7,5	100S56-2706G	100S56-2707G	100S56-2708G	100S56-2709G
	10	100S56-2706H	100S56-2707H		
	15	100S56-2706J	100S56-2707J		
1500	5	100S56-2806F	100S56-2807F	100S56-2808F	100S56-2809F
	7,5	100S56-2806G	100S56-2807G	100S56-2808G	100S56-2809G
	10	100S56-2806H	100S56-2807H		
	15	100S56-2806J	100S56-2807J		
1600	5			100S56-2908F	100S56-2909F
	7,5	100S56-2906G	100S56-2907G	100S56-2908G	100S56-2909G
	10	100S56-2906H	100S56-2907H		
	15	100S56-2906J	100S56-2907J		

		Best.-Nr.
	Schnappbefestigung	-
	Plombierplatte Form C	10059042

SASK 105.6

Schutz-Aufsteck-Stromwandler



Schiene 1 100 x 55 mm
 Rundleiter 55 mm
 Baubreite 129 mm
 Bauhöhe 167 mm
 Bautiefe gesamt 78 mm

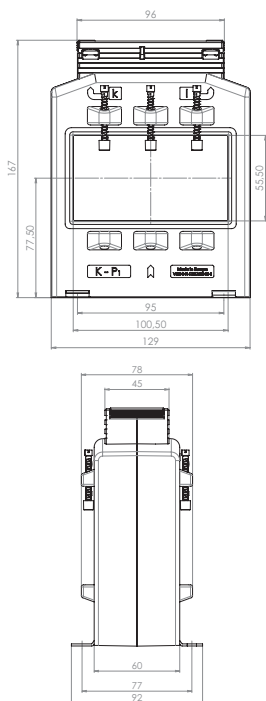

Primärstrom [A]	Bürde [VA]	Sekundärstrom [A] / Klasse			
		1 A Kl. 5P5 Best.-Nr.	1 A Kl. 10P5 Best.-Nr.	1 A Kl. 5P10 Best.-Nr.	1 A Kl. 10P10 Best.-Nr.
600	2,5	100S56-2216C	100S56-2217C	100S56-2218D	100S56-2219D
	5	100S56-2216F	100S56-2217F		100S56-2219F
750	2,5	100S56-2316C	100S56-2317C	100S56-2318D	100S56-2319D
	5	100S56-2316F	100S56-2317F	100S56-2318F	100S56-2319F
	7,5	100S56-2316G	100S56-2317G		
	10	100S56-2316H	100S56-2317H		
1000	5	100S56-2516F	100S56-2517F	100S56-2518F	100S56-2519F
	7,5	100S56-2516G	100S56-2517G	100S56-2518G	100S56-2519G
	10	100S56-2516H	100S56-2517H		
1200	5	100S56-2616F	100S56-2617F	100S56-2618F	100S56-2619F
	7,5	100S56-2616G	100S56-2617G	100S56-2618G	100S56-2619G
	10	100S56-2616H	100S56-2617H		
	15	100S56-2616J	100S56-2617J		
1250	5	100S56-2716F	100S56-2717F	100S56-2718F	100S56-2719F
	7,5	100S56-2716G	100S56-2717G	100S56-2718G	100S56-2719G
	10	100S56-2716H	100S56-2717H		
	15	100S56-2716J	100S56-2717J		
1500	5	100S56-2816F	100S56-2817F	100S56-2818F	100S56-2819F
	7,5	100S56-2816G	100S56-2817G	100S56-2818G	100S56-2819G
	10	100S56-2816H	100S56-2817H		
	15	100S56-2816J	100S56-2817J		
1600	5			100S56-2918F	100S56-2919F
	7,5	100S56-2916G	100S56-2917G	100S56-2918G	100S56-2919G
	10	100S56-2916H	100S56-2917H		
	15	100S56-2916J	100S56-2917J		

		Best.-Nr.
	Schnappbefestigung	-
	Plombierplatte Form C	10059042

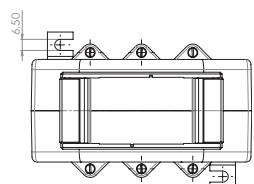



WIR MACHEN IHRE WERTE SICHTBAR.



Die im Produktkatalog enthaltenen Daten sind nach besten Wissen und Gewissen erstellt. Änderungen und Irrtümer sind ausdrücklich vorbehalten. Abbildungen ähnlich stellen keine Vertragsbedingungen im Sinne von § 305 I BGB dar. Es handelt sich um Hinweise ohne eigenständigen Regelungsgehalt, die lediglich zum Ausdruck bringen, dass die im Katalog enthaltenen Angaben insoweit vorläufig und unverbindlich sind, als sie vor oder bei Abschluss eines Vertrags noch korrigiert werden können. Ein vertraglicher Regelungsgehalt, insbesondere eine etwaige Beschränkung der Rechte des Vertragspartners in haftungs- oder gewährleistungsrechtlicher Hinsicht, kann diesen Hinweisen nicht entnommen werden.

Gilgen, Müller & Weigert (GMW) GmbH & Co. KG

Am Farnbach 4A
90556 Cadolzburg

Tel: +49 (0) 9103 7129-0
Fax: +49 (0) 9103 7129-205/207
E-Mail: info@g-mw.de
Internet: www.g-mw.de

Geschäftsführer: Prof. Dr. h.c. Wolfgang Gilgen

Umsatzsteuer Identifikationsnummer: DE815535316

Weitere Informationen sowie Lieferbedingungen
und den aktuellen Katalog finden Sie bei uns im
Internet:

www.g-mw.de